

Build instructions for the Bathurst building #043



Fragile kit, please handle pieces with care.

First of all, thank you for purchasing one of our kits and we hope you enjoy building it as much as we did creating it. As always, please send us your feedback and a picture of your completed building on your track.

Below are a few images to help you get some painted ideas on how to paint your Bathurst Timekeepers

***A few hints and tips before we get started ***

- Always dry assemble a part before applying glue, this way you are confident that the part fits easily and there is no worry that the glue will dry before you have the part fully fitted.

-Our tolerances are tight, so if you come across a tight lug you'll need to scrape a sharp craft knife along the top and bottom surfaces of the male lug as this produces a small chamfer to help you guide the part in. Having said that, the parts are generally very accurate, and we have left clearances where we can, so in most cases this isn't necessary.

- Some of our products are supplied in a sheet format with the parts held in place on tiny spews. If you have one of these products, then cut the spew with a sharp craft knife then push the part out. You may need to cut the spew remains from the part.

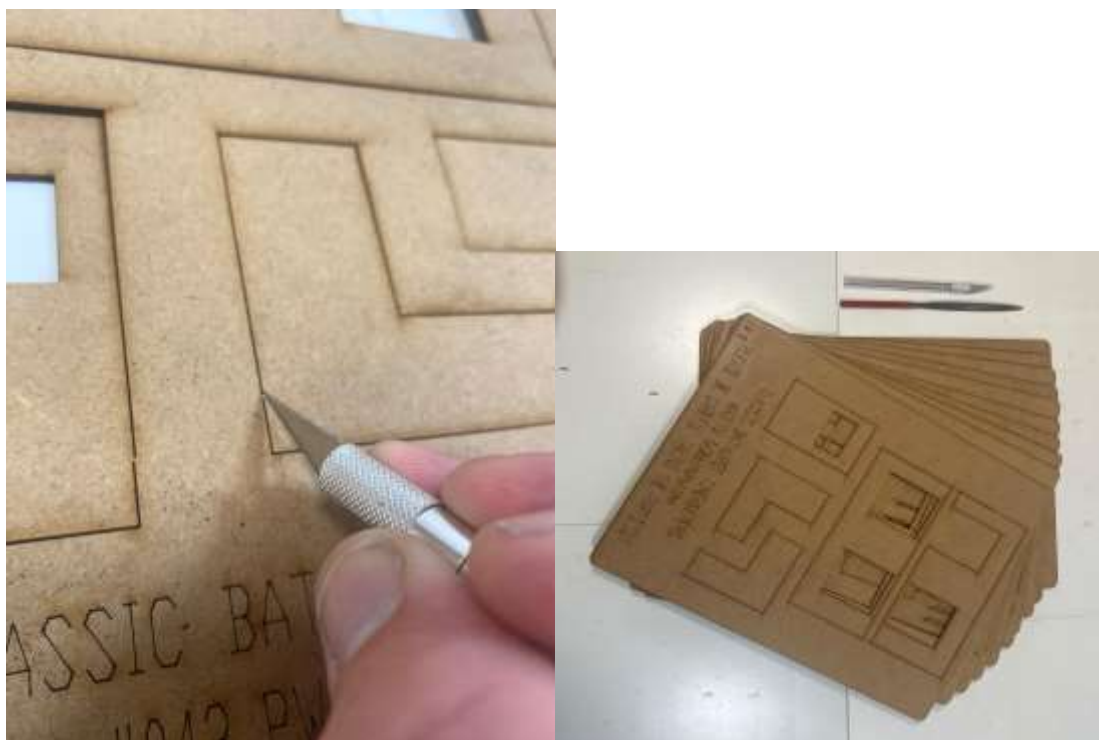

-We also recommend using a super glue GEL, as this helps to hold the pieces in position as they dry and doesn't get absorbed by the MDF; however, most types of glue will work and your personal preference will be fine. Usually, a small amount of glue will suffice and hold the part in place.



-When gluing two parts at right angles to each other use another unused part in the kit as an angle gauge pressed up against both parts. This way you will get them glued squarely to each other. Some kits are supplied with our handy right angle guide tool.

-It is advisable to sometimes use a small piece of tape or pegs to help hold pieces together while drying as a piece that slides even 1mm or 2mm out of place can really affect later steps in the build.

-Use a cotton bud to wipe away any excess glue before it dries as dried lumps of glue can ruin the finished model.

-If you want to paint this item then you may want to pause at certain steps to paint.

-Laser cut items are 'sided' so unless stated we design all our buildings with what we call the 'nice side' visible.



STEP 1

Select these pieces from the sheets of parts.

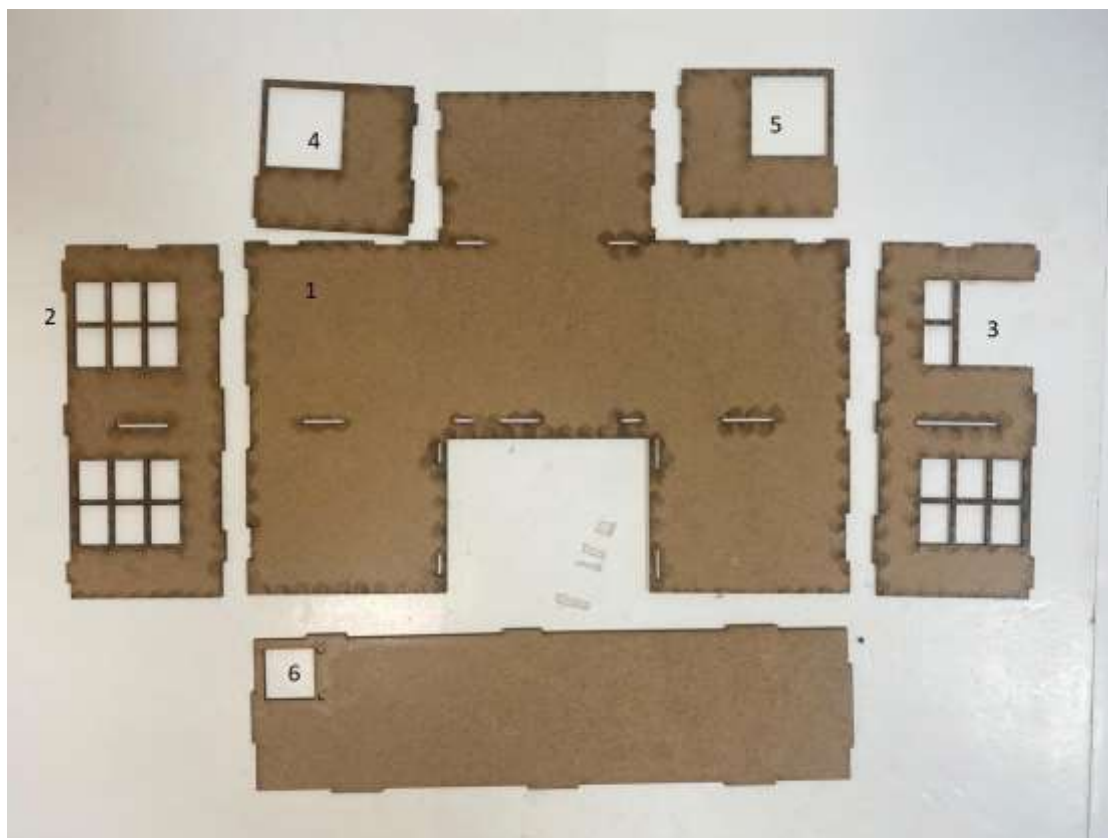

Fit piece 6 to part 1 making sure the access hatch is on the left like in the diagram below.

The 'Nice Side' of part 1 will be face down as this will be the interior of the building.



STEP 2

We can now fit pieces 2 and 3 like in the images below.

These should only fit the correct way around. The 'Nice side' will be out wards facing.

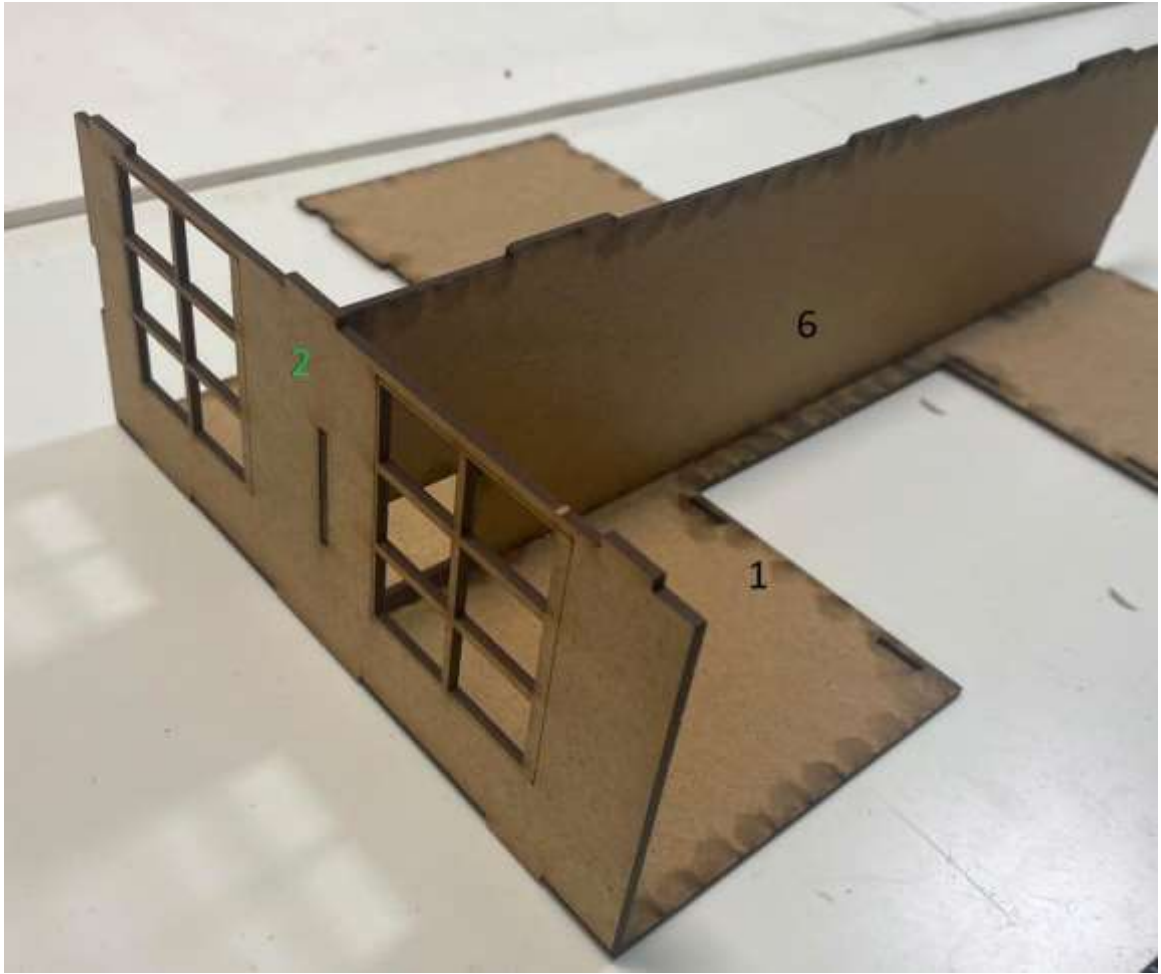

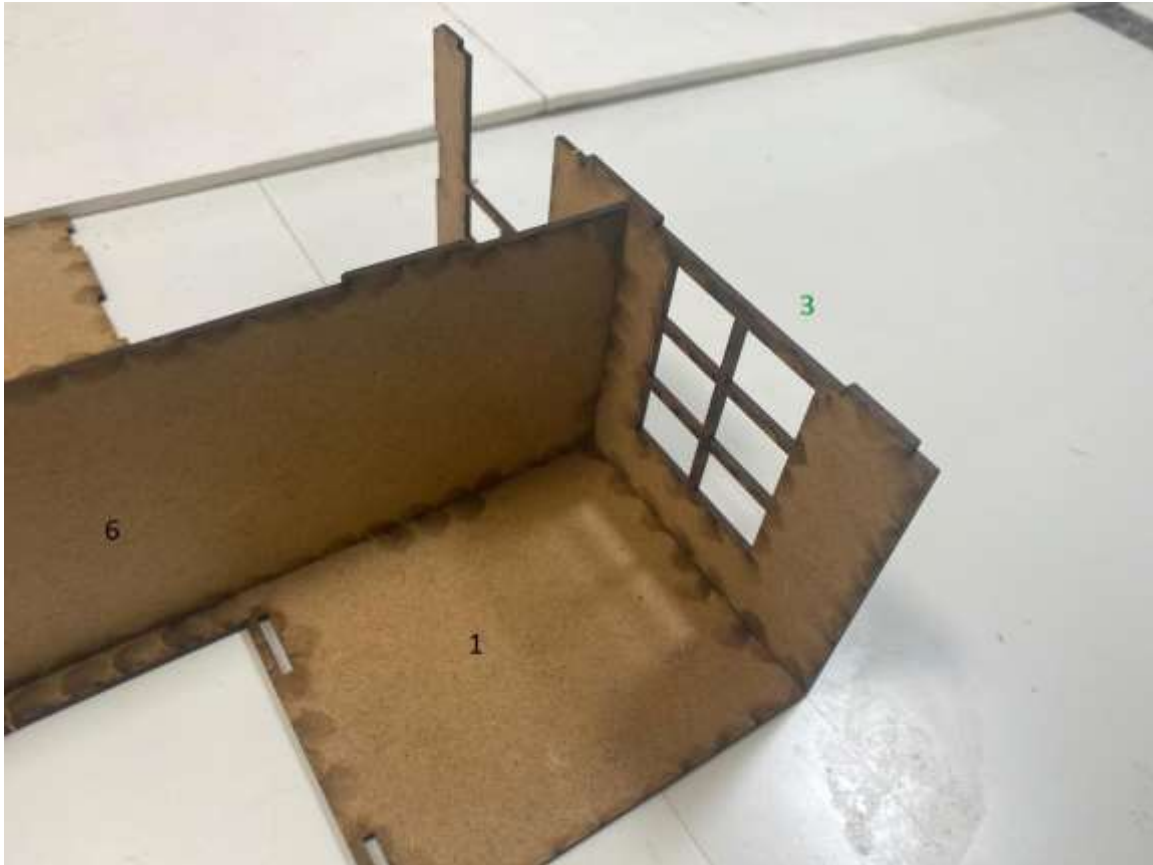

STEP 3

Select piece 7 from the kit and fit this onto piece 1 like the diagram below. We suggest laying piece 1 down and fixing piece 7 onto it whilst it's laying down - this will help the top floor dry straight.



STEP 4

Now we can fit the top floor walls which are pieces 4 and 5.

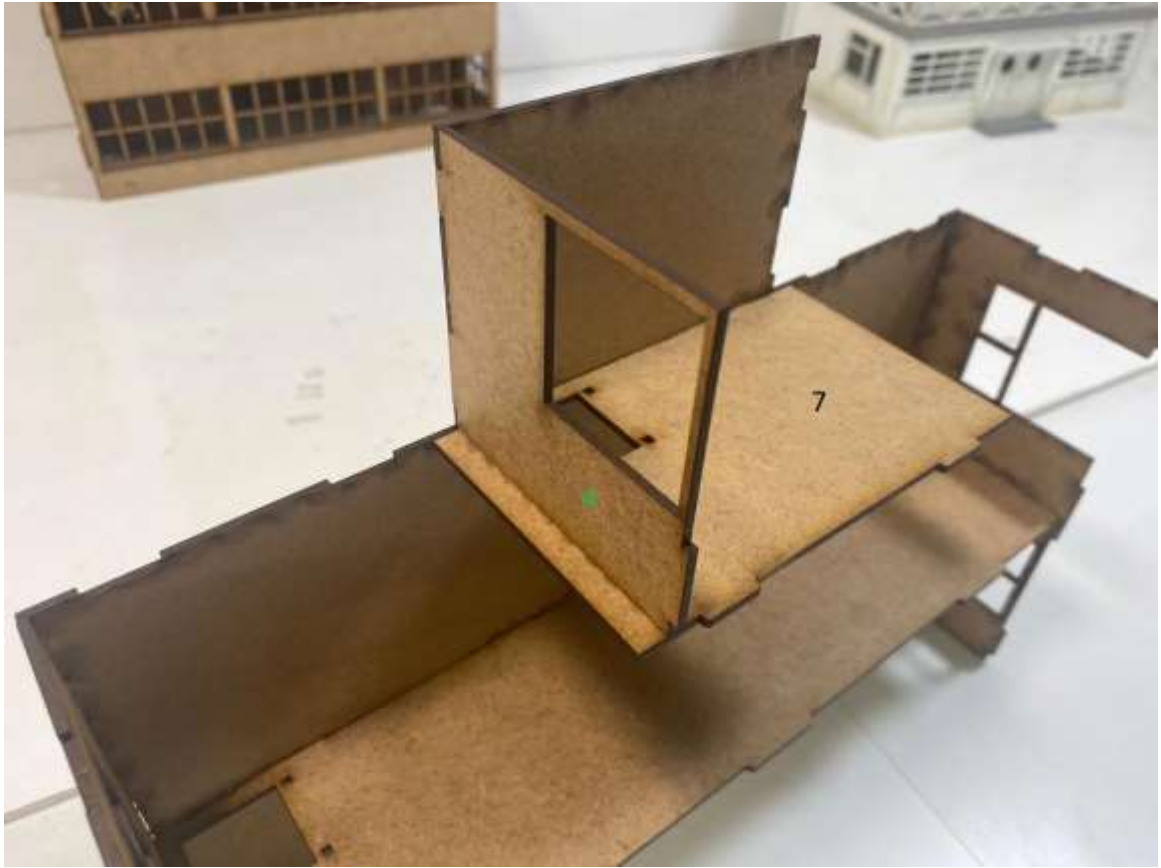

STEP 5

While the access is still really good, we can fit the ladder safety rails (pieces 8a & b). We have designed this building with gaining access to create awesome interiors in mind so if you wish you can fit these last (It just may be easier to do it now, so your choice)

The etched lines on pieces 8a & b are there to help you know how far to insert them into the floor.

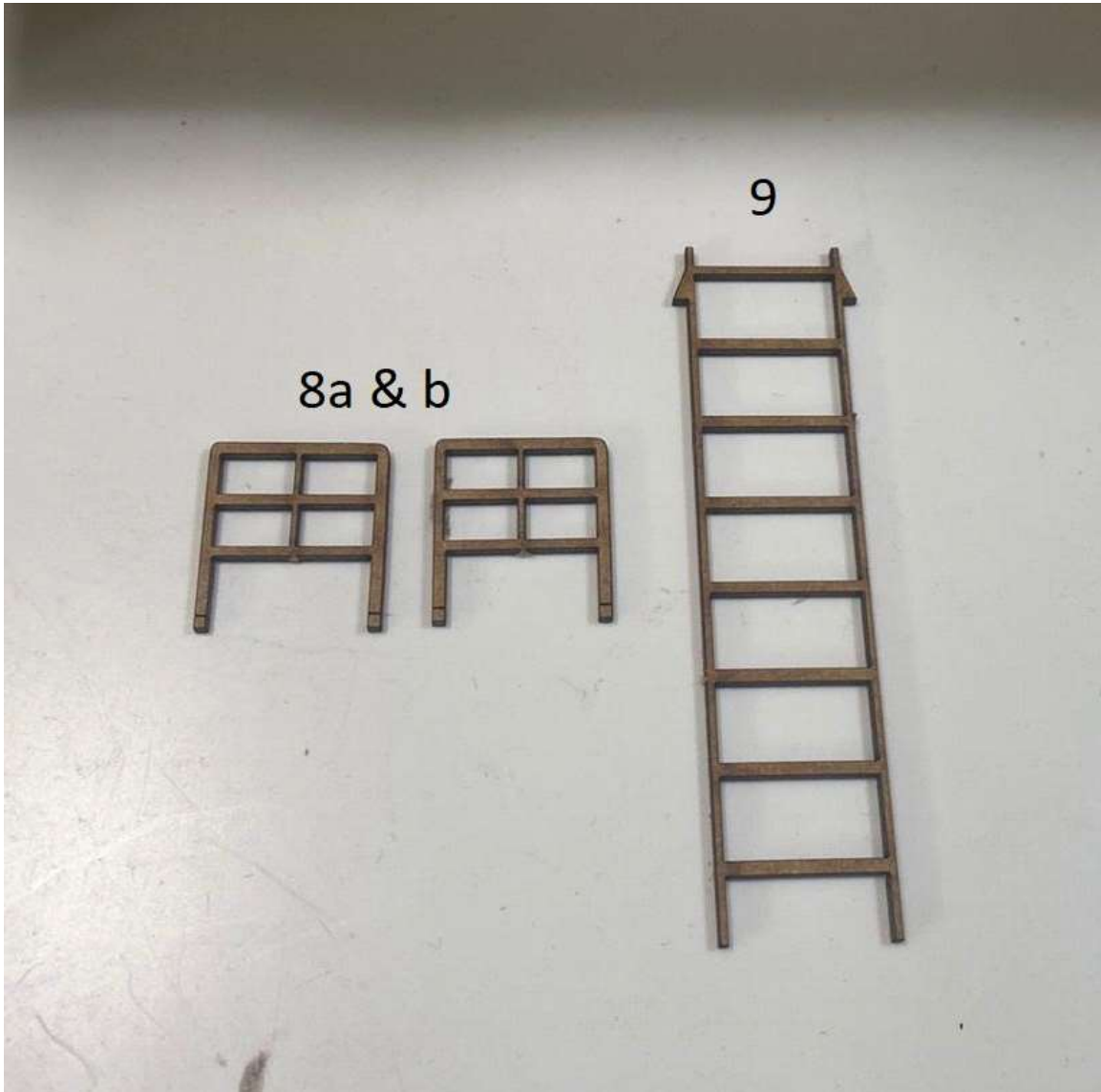



STEP 6

Next step will see the building really taking shape. Select piece 10 and fit it to the main structure 'Nice Side' facing out.

There are quite a few lugs to locate here so be patient and take your time.

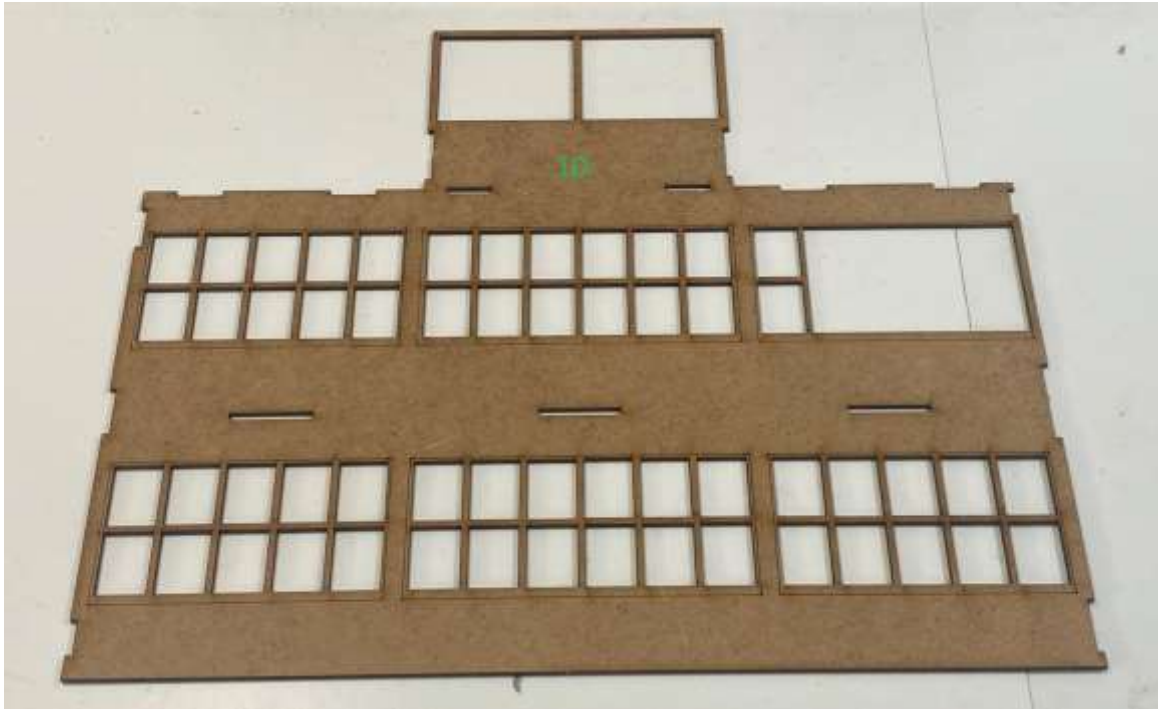

STEP 7

We now need pieces 11,12 and 13 from the kit which are the front and side outer walls.

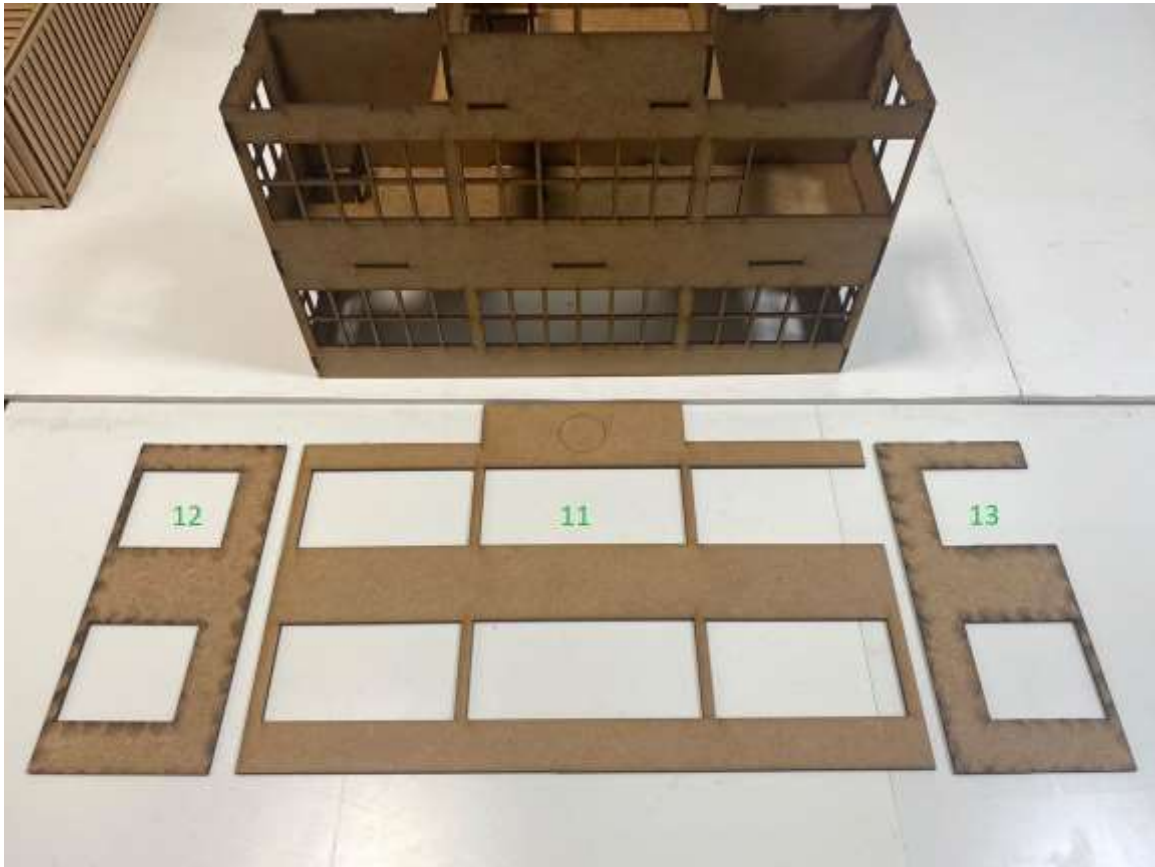

Around each window on the inner walls, you will see an etched line, this is to help you line up the outer wall.

We recommend dry fitting this piece first, so you understand the exact fitment.

Fit the two side walls first as they are easier to line up as they are the exact size of the inner walls.

Once these are done the fit the front outer wall.

Use the images below to help.



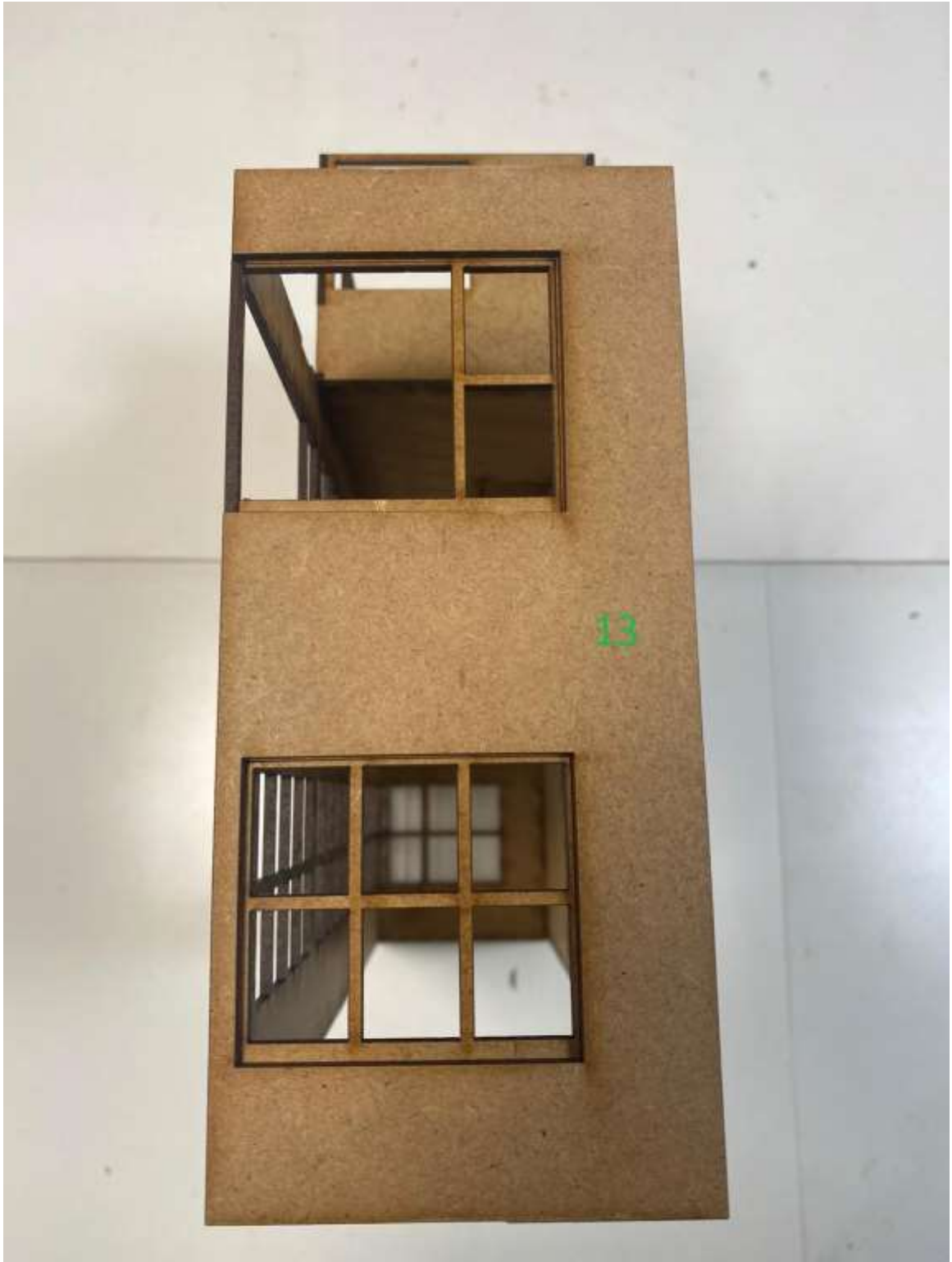

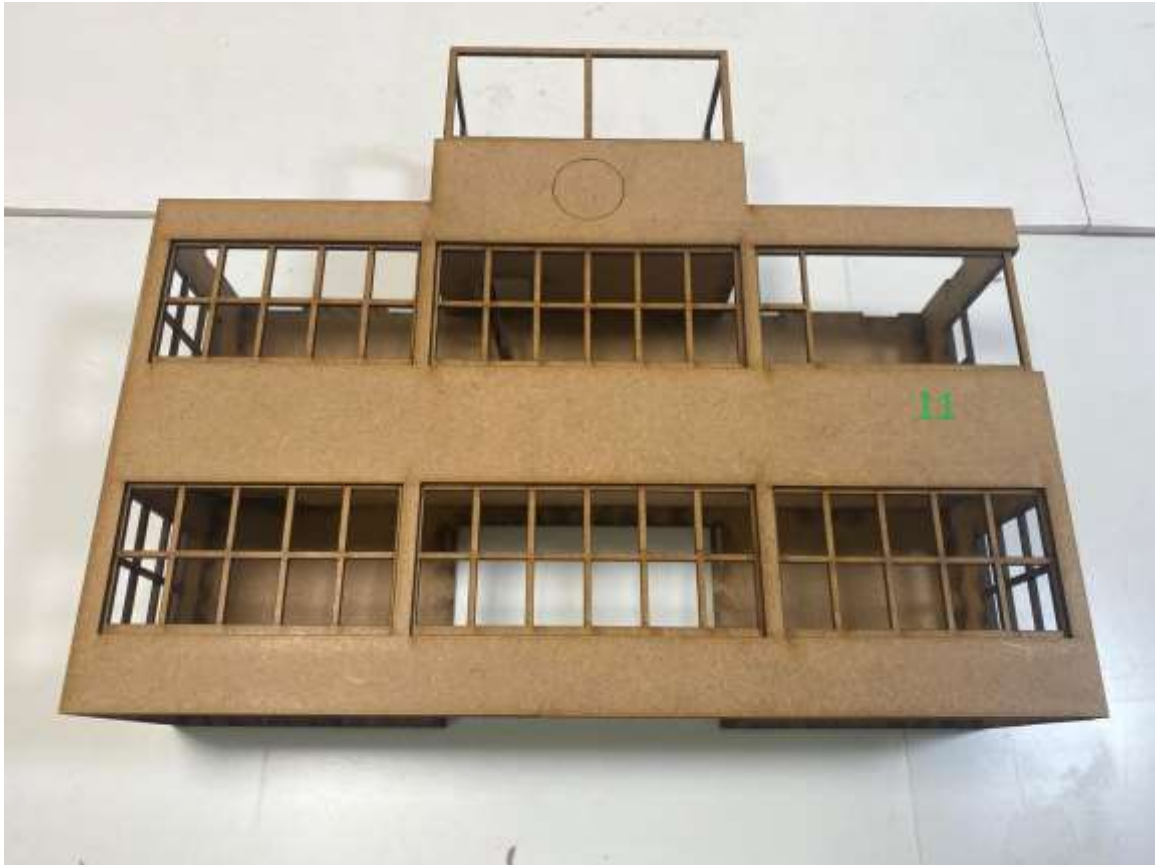

STEP 8

Let's find the rear outer wall now (piece 14)

The four main corners should all match up exactly, use the images below to help and once again dry fit to make sure you understand exactly how this needs to be fitted.

Make sure you do not cover any of the lug holes in the middle of the inner wall.

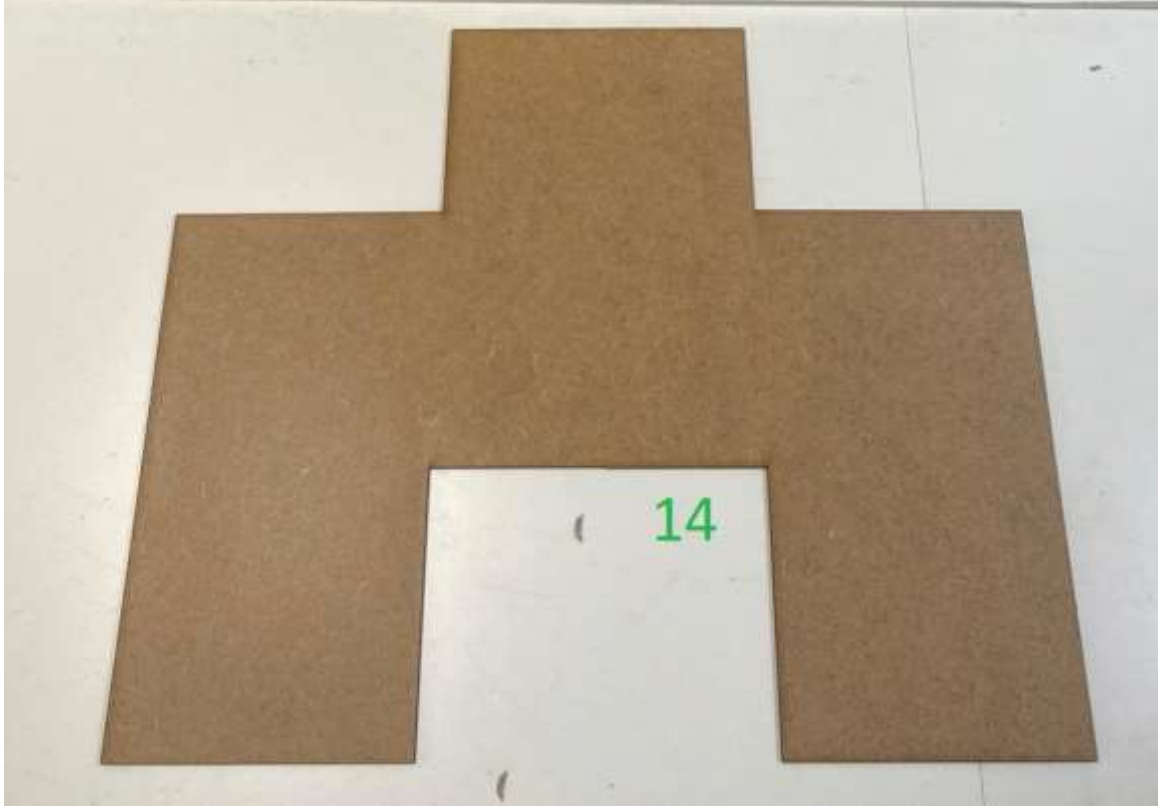

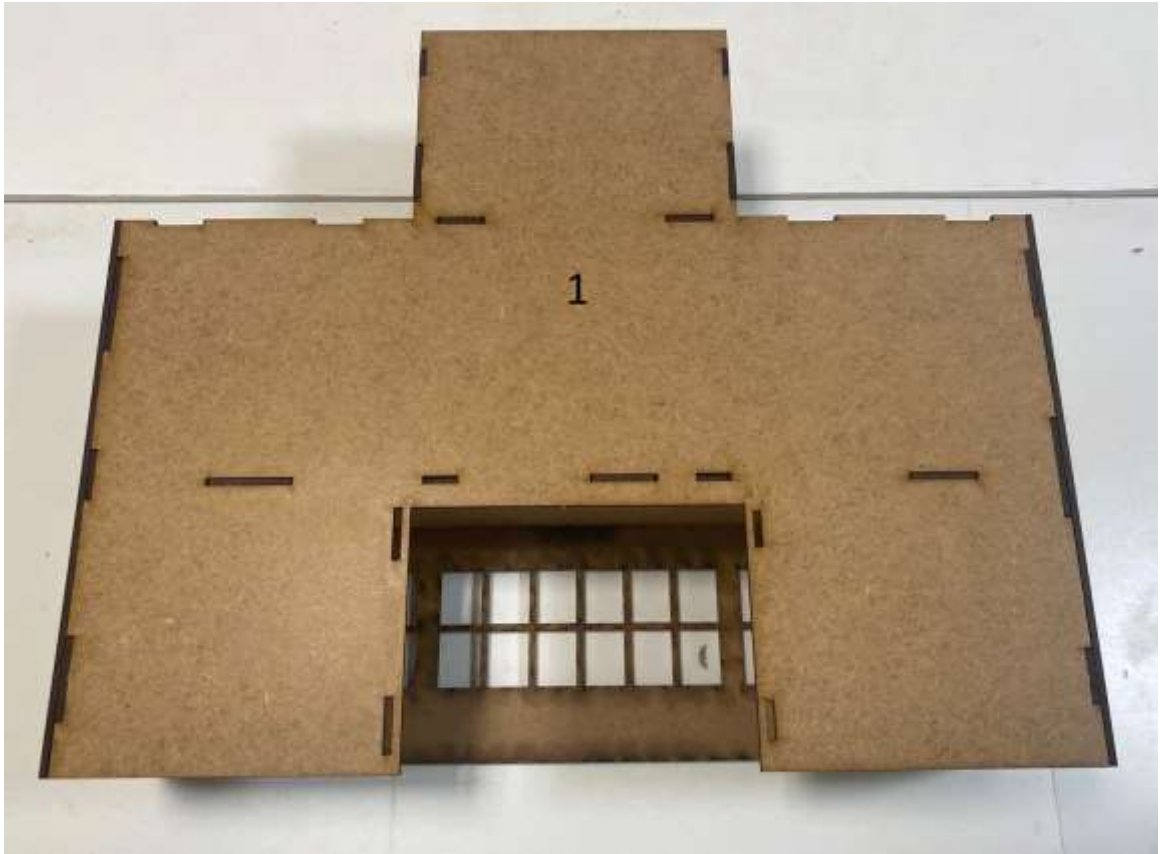

All corners will line up exactly.

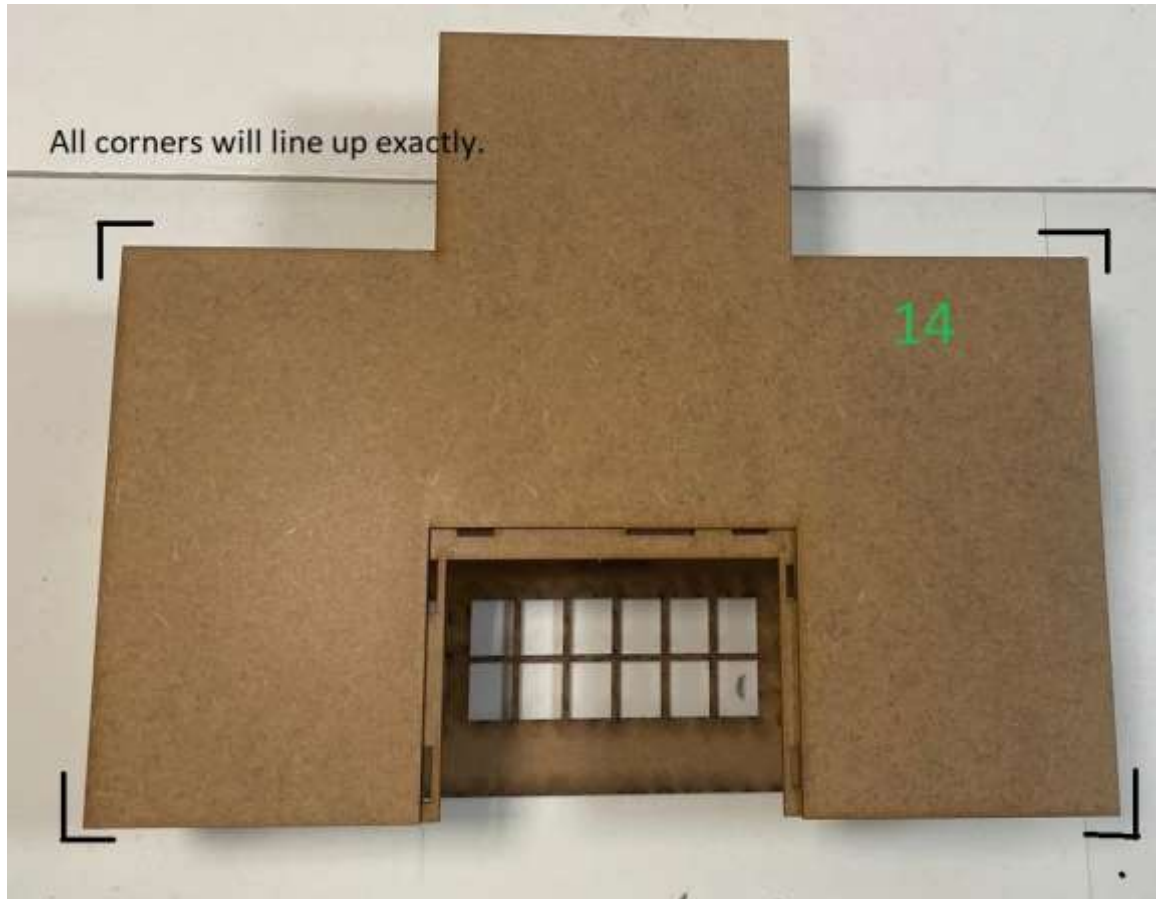



STEP 9

Time to find the last of the outer walls. pieces 15 and 16.

These fit on in the same way the others did, use the etched lines around the windows on the inner walls as a guide.

Piece 15 on the
Left.

Piece 15 on the
right.

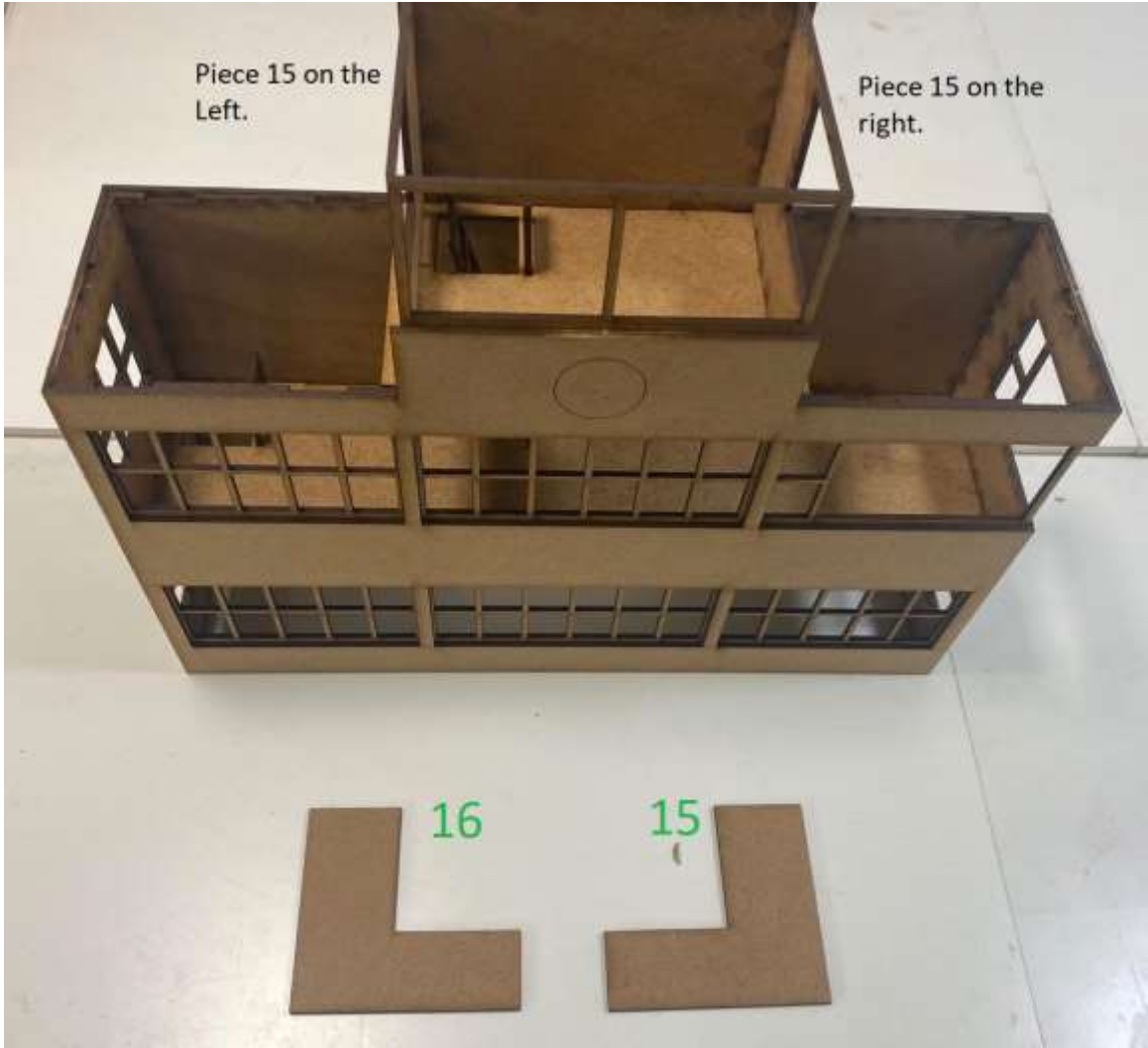

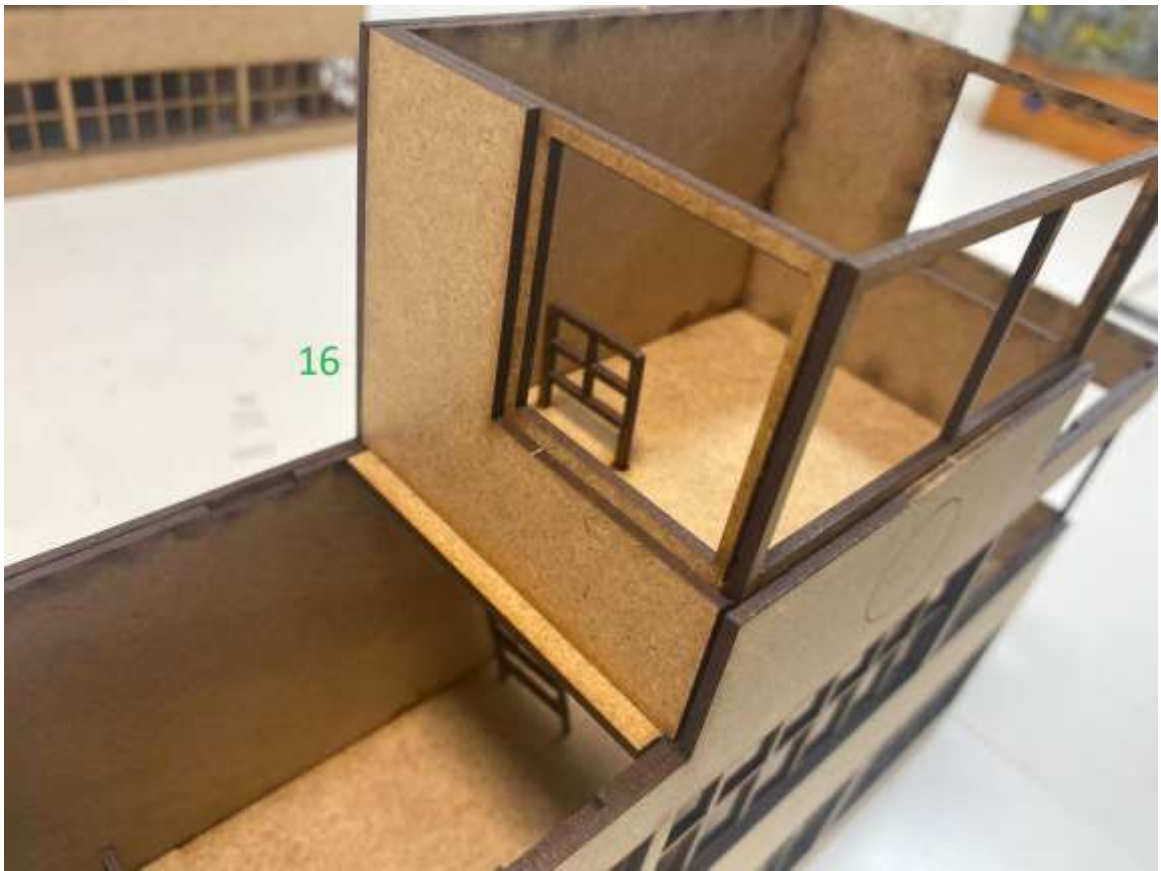
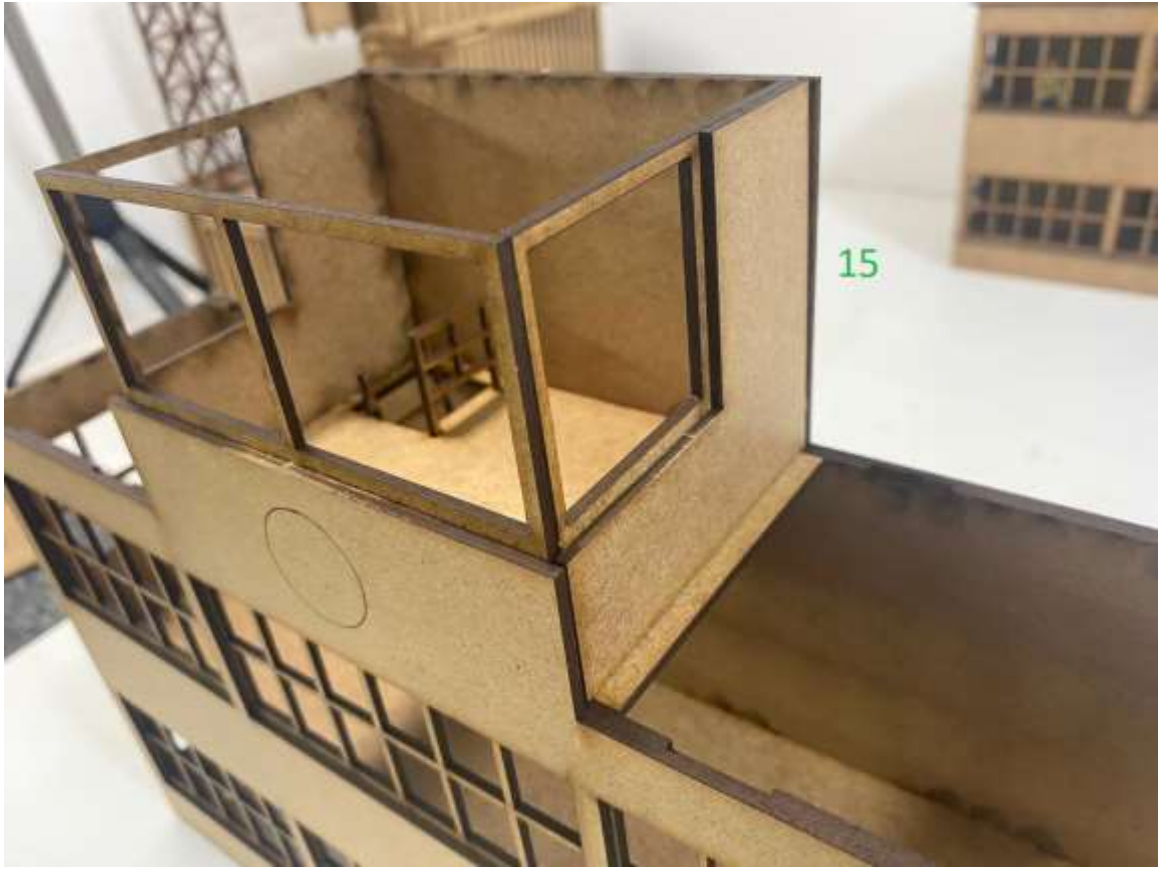

STEP 10

*****DO NOT GLUE THE ROOF PIECES TO THE MAIN BUILDING*****

The roof sections are designed to just sit in place so they can be removed to fit and adjust interiors.

PLACE pieces 17 and 18 into their homes - Do not glue these

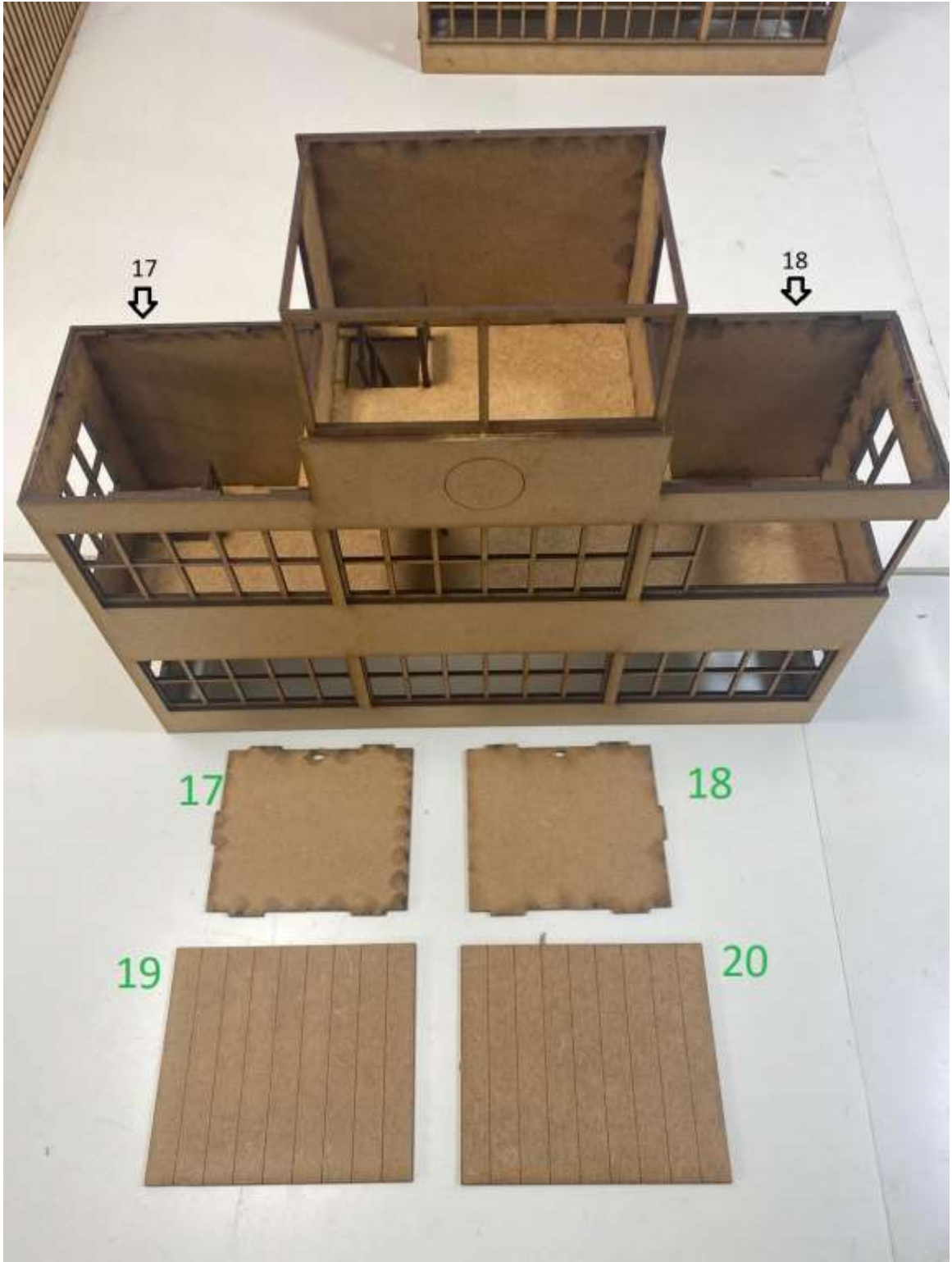

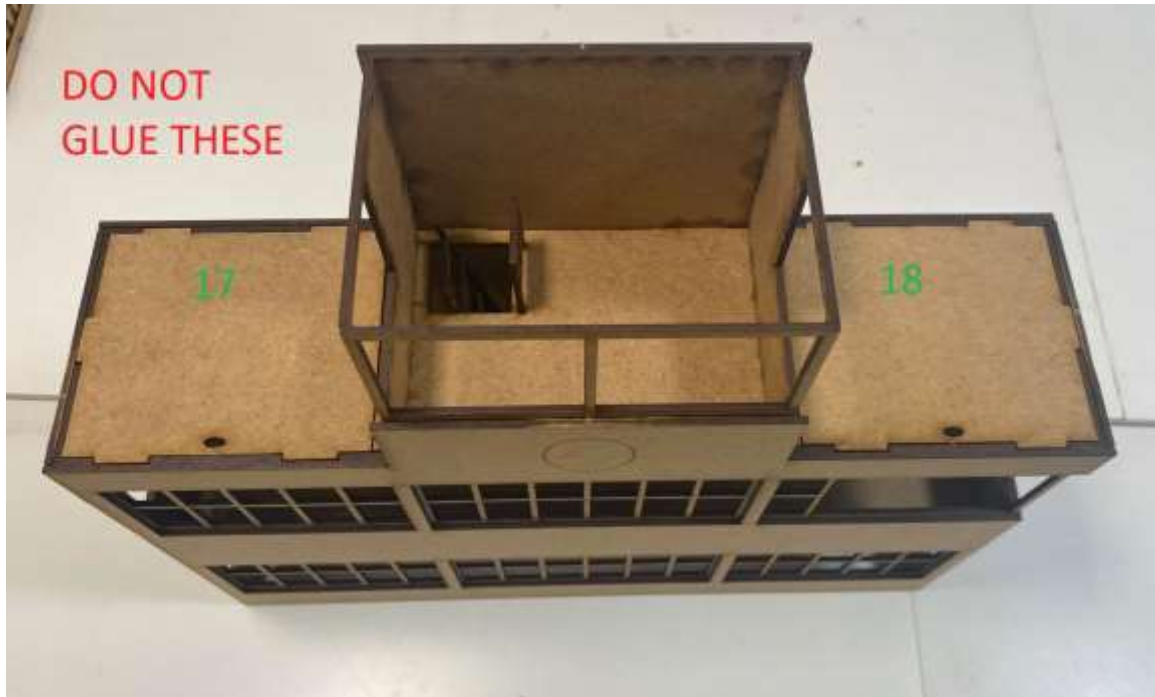

Apply some glue to the top of pieces 17 and 18 taking care not to get glue on any of the joints.

Then place pieces 19 and 20 onto these. These will overhang on the front, rear and outer sides. The inner part of the roof can be pushed towards the top floor wall.

Once this glue has dried you will be able to lift of the roof sections to gain access into the building.



STEP 11

You have 2 options here.

- 1- We have supplied a blanking piece with a door and frame that makes the rear of the building completely flat.
- 2- The small outbuilding that is on the original building.

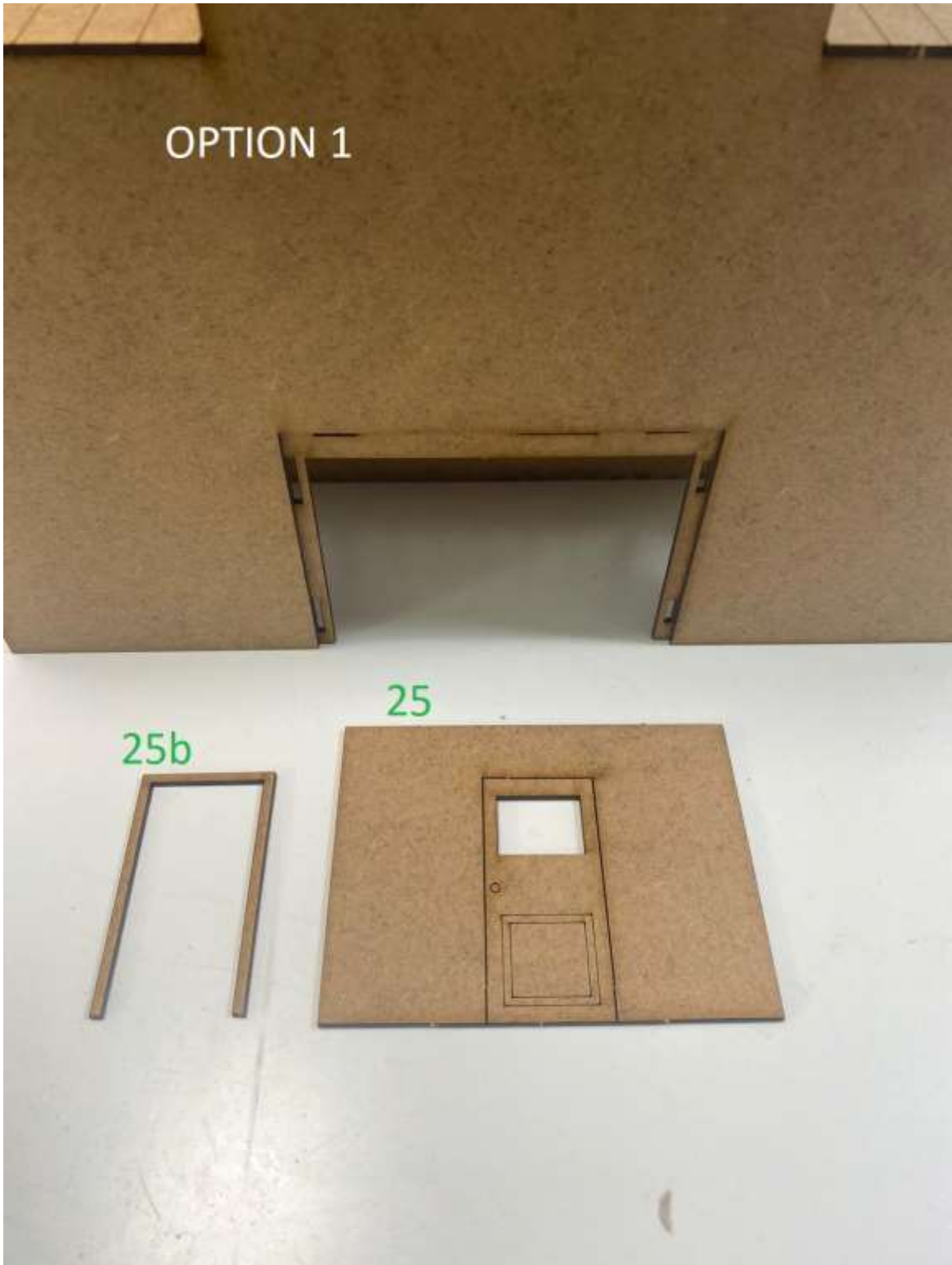

These just fit onto the rear.

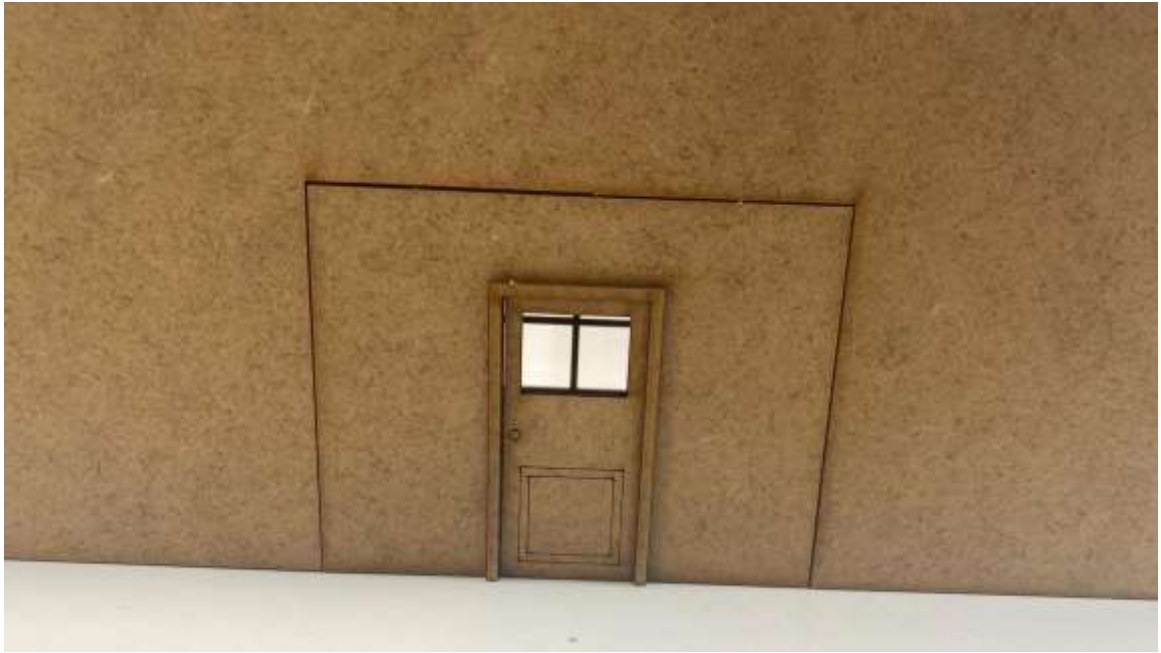

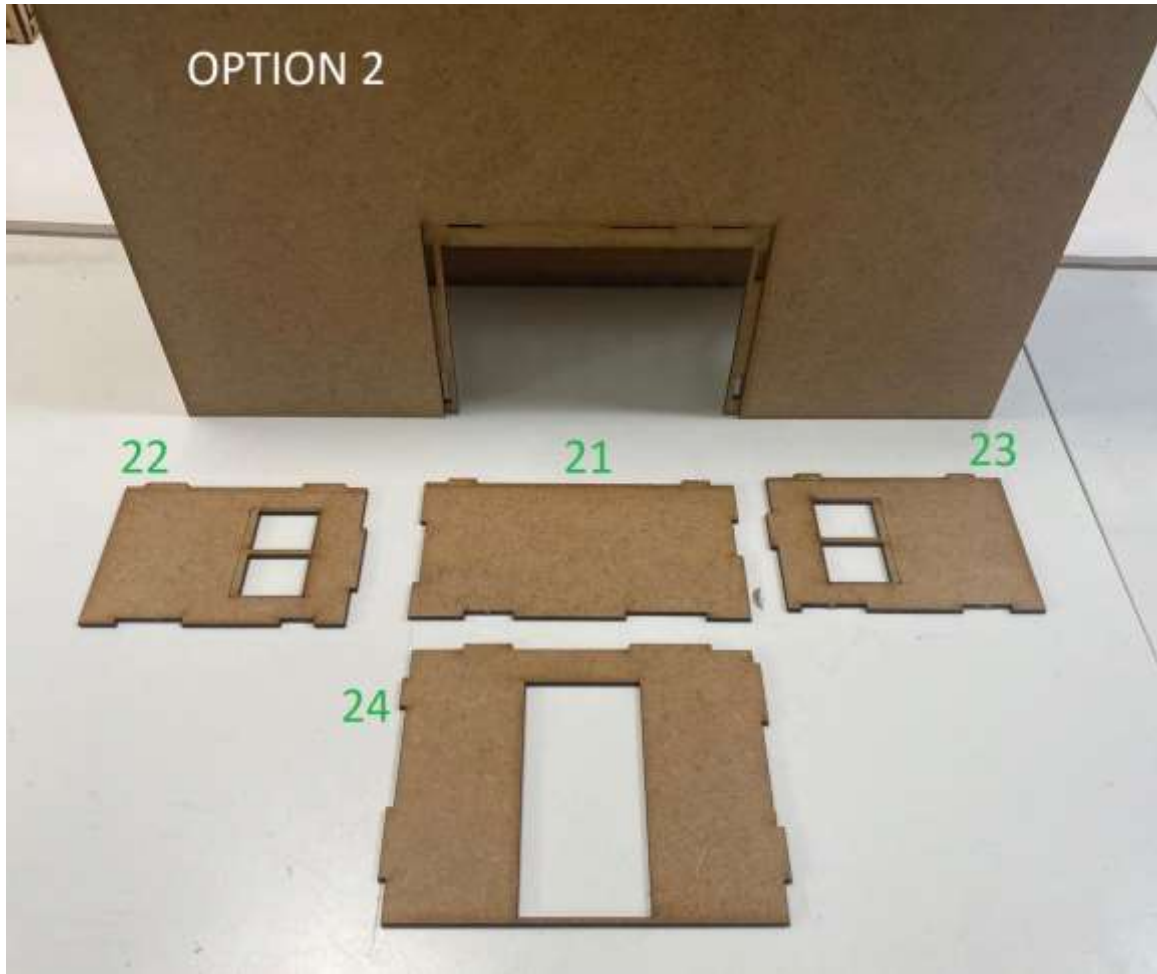

Please follow the diagrams below to make the outbuilding.

If the outer wall is slightly out of line the next few pieces may be of a tight fit, if this is the case then use a sharp craft knife to trim the lugs a little to help get a good joint.

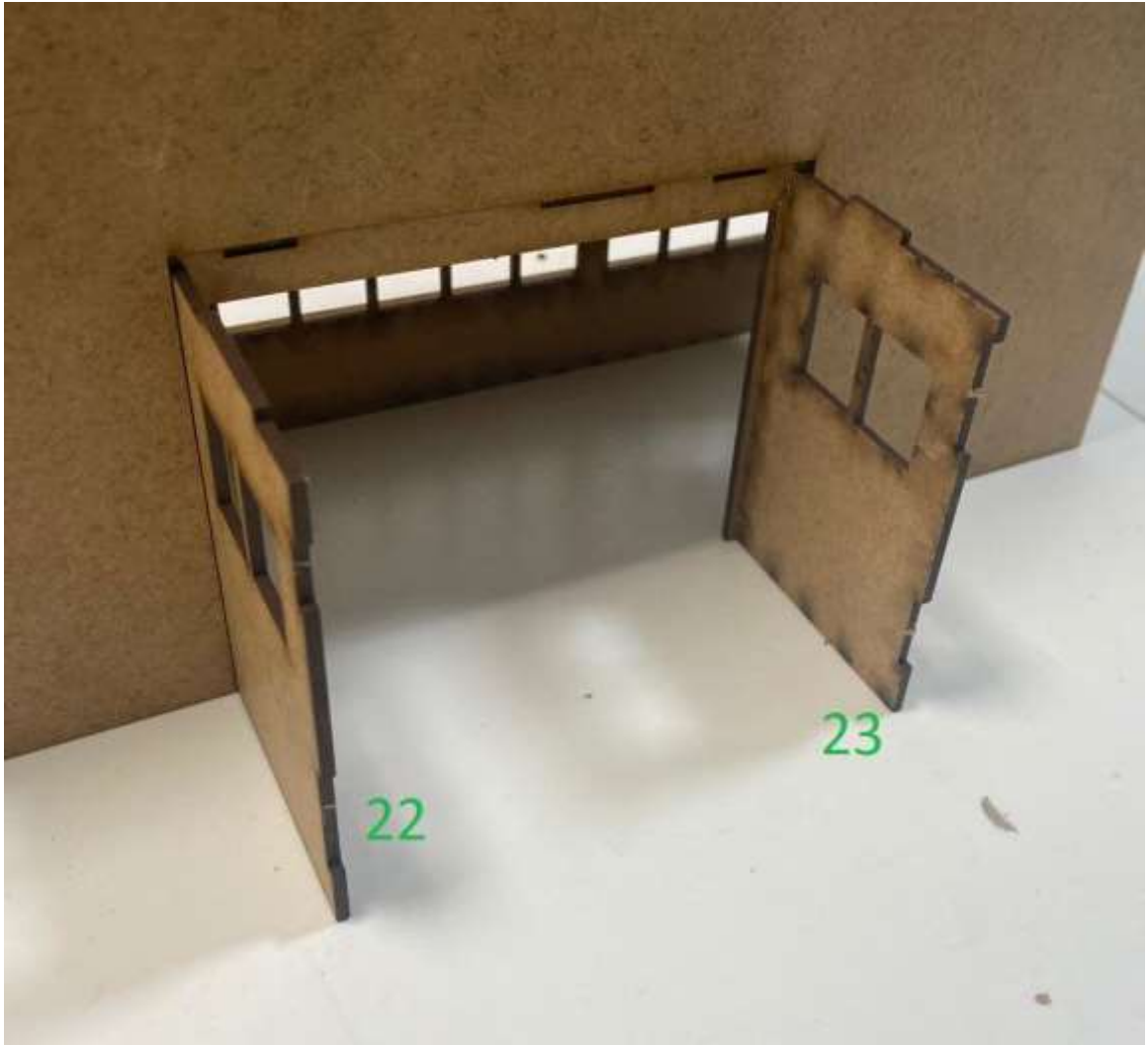



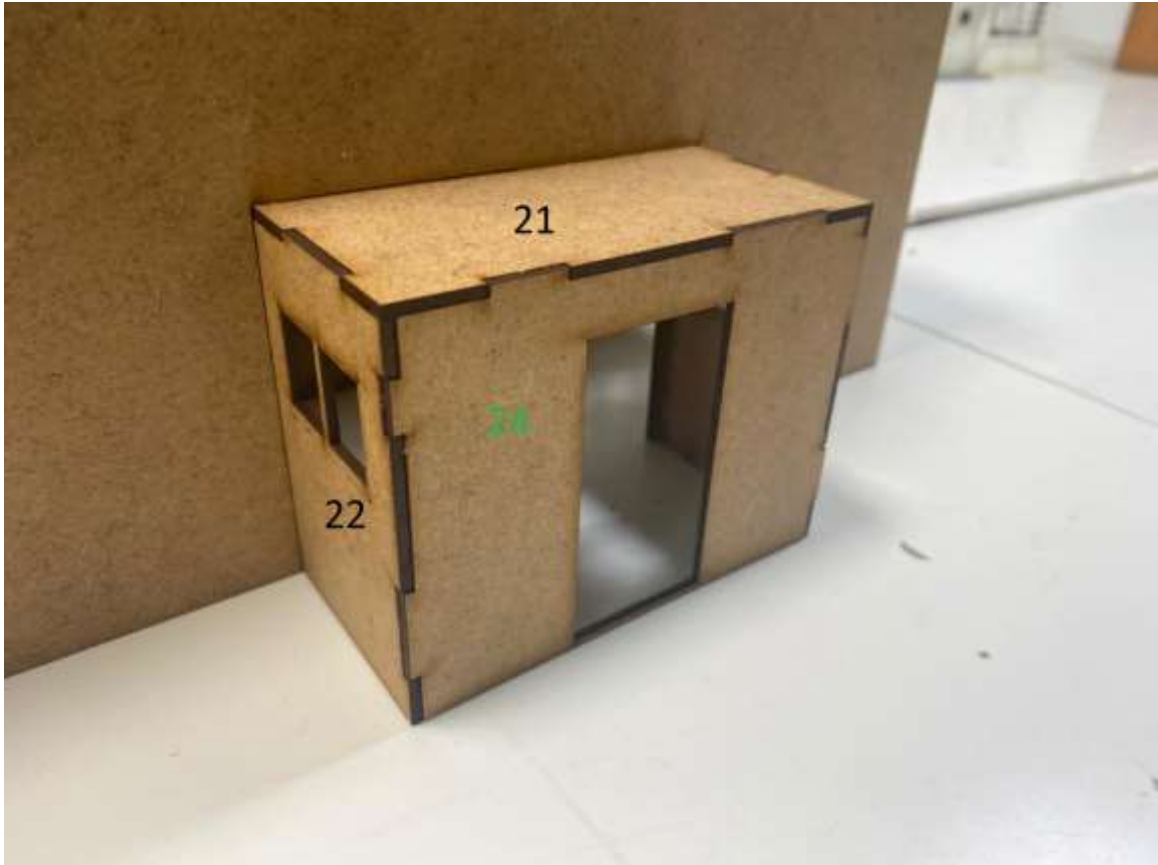

STEP 12

Our next step is to fit the outer walls on our small outbuilding.

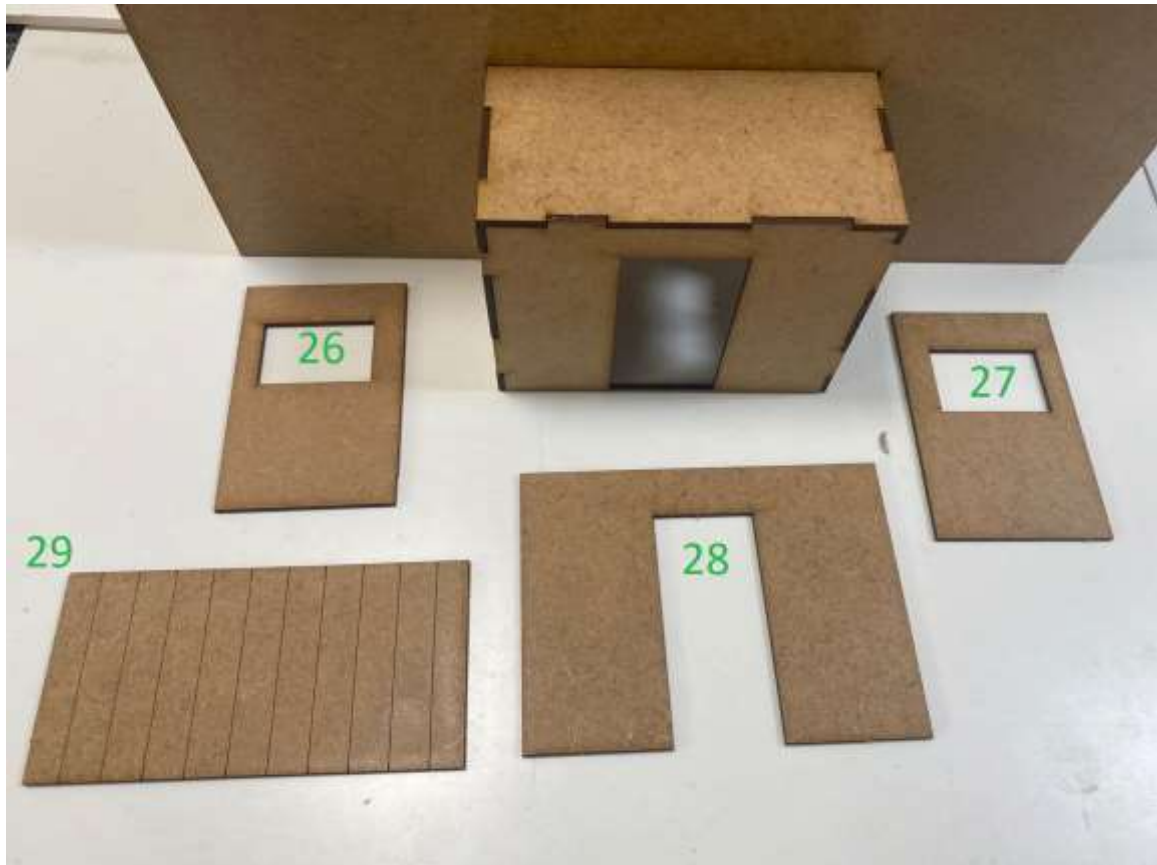

Remember to fit the walls 'Nice Side' outwards facing.

The windows on pieces 26 and 27 are slightly off centre, piece 26 goes on the left as you look at the building from the rear.





STEP 13

We can put the main building to one side for now and make a start on the top roof structure.

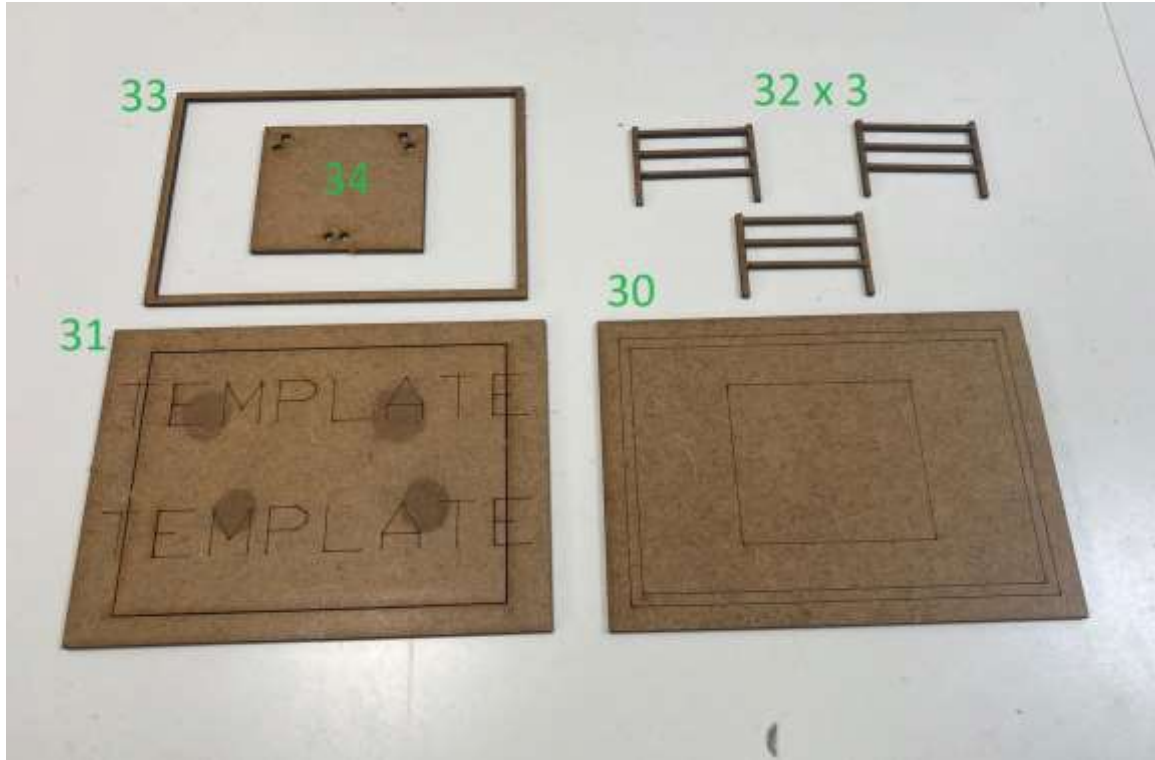

Turn piece 30 over so the etched markings are face down.

Now apply glue to the middle square of the template piece (piece 31) and place both parts of the template on the upside down roof piece (piece 30) you can then remove the outer template surround leaving the middle square in the centre of piece 30.



You can now turn this over.

Fit piece 34 onto the top, this piece fits in the etched square in the middle.

The holes circled below need to be fitted nearest a long side.

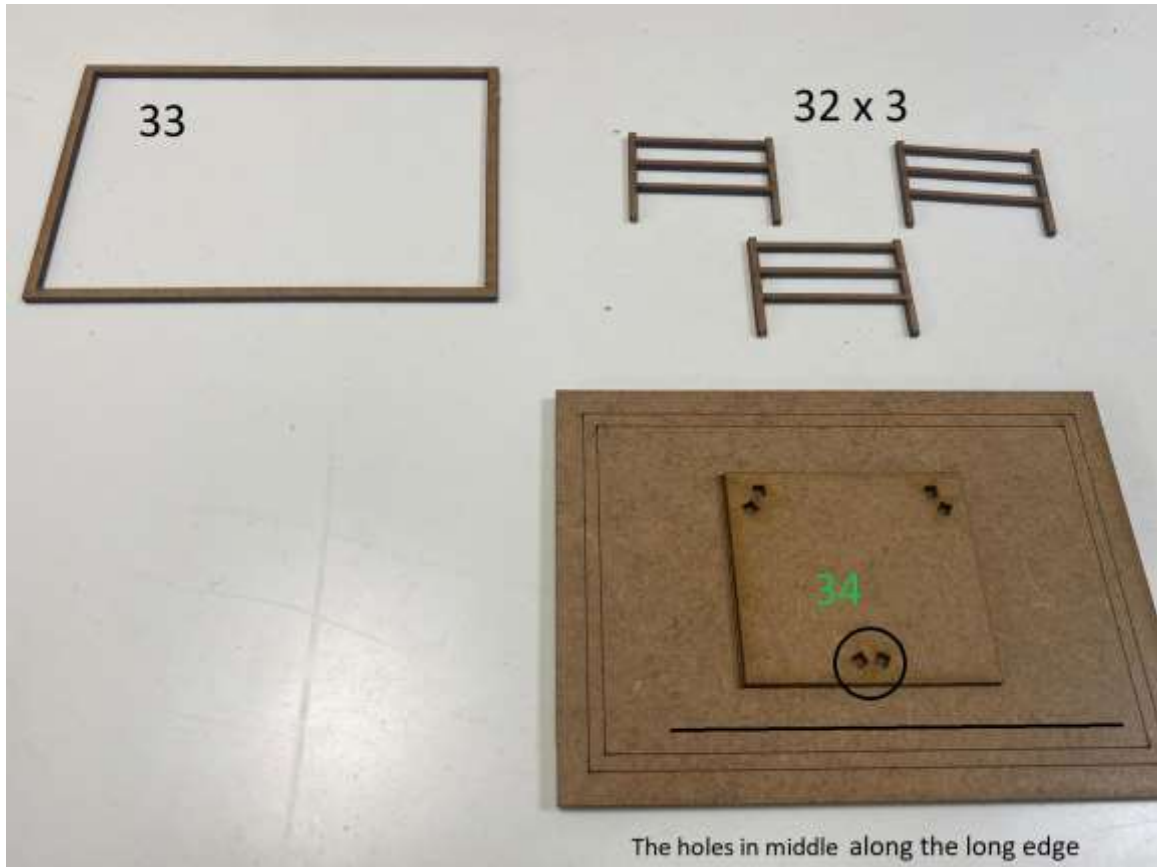

Next, we can fit the 3 sign supports (Pieces 32)

Then piece 33 can be stuck down between the etched markings.

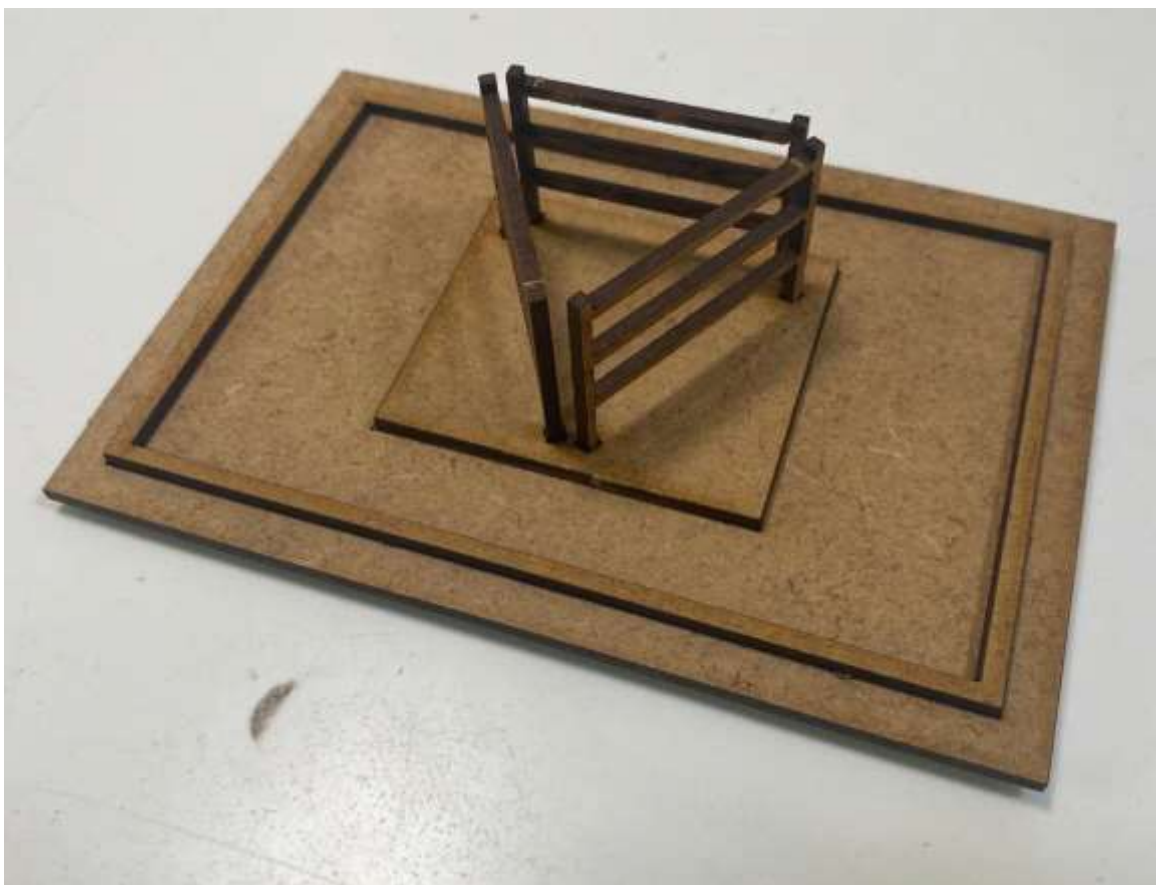
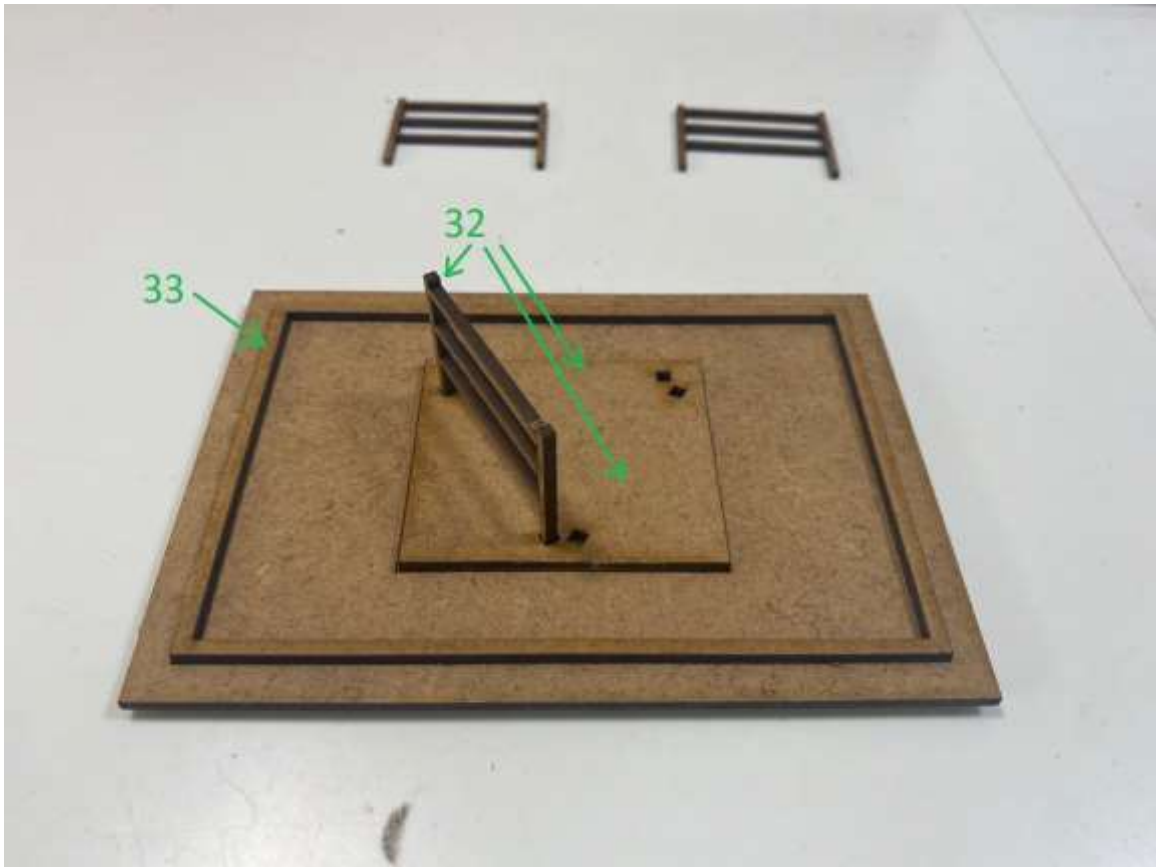

The next set of pieces you want to find are the thinner 1mm bits.

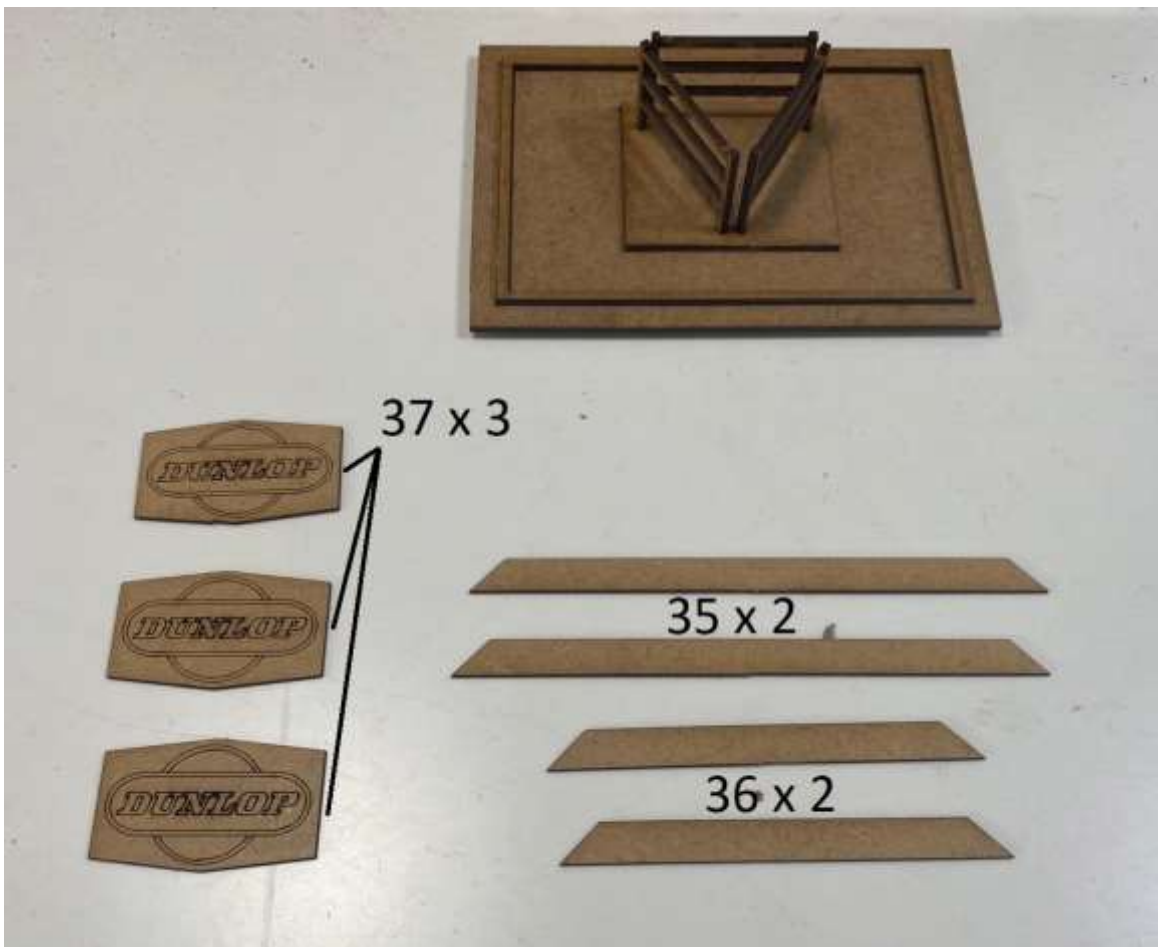
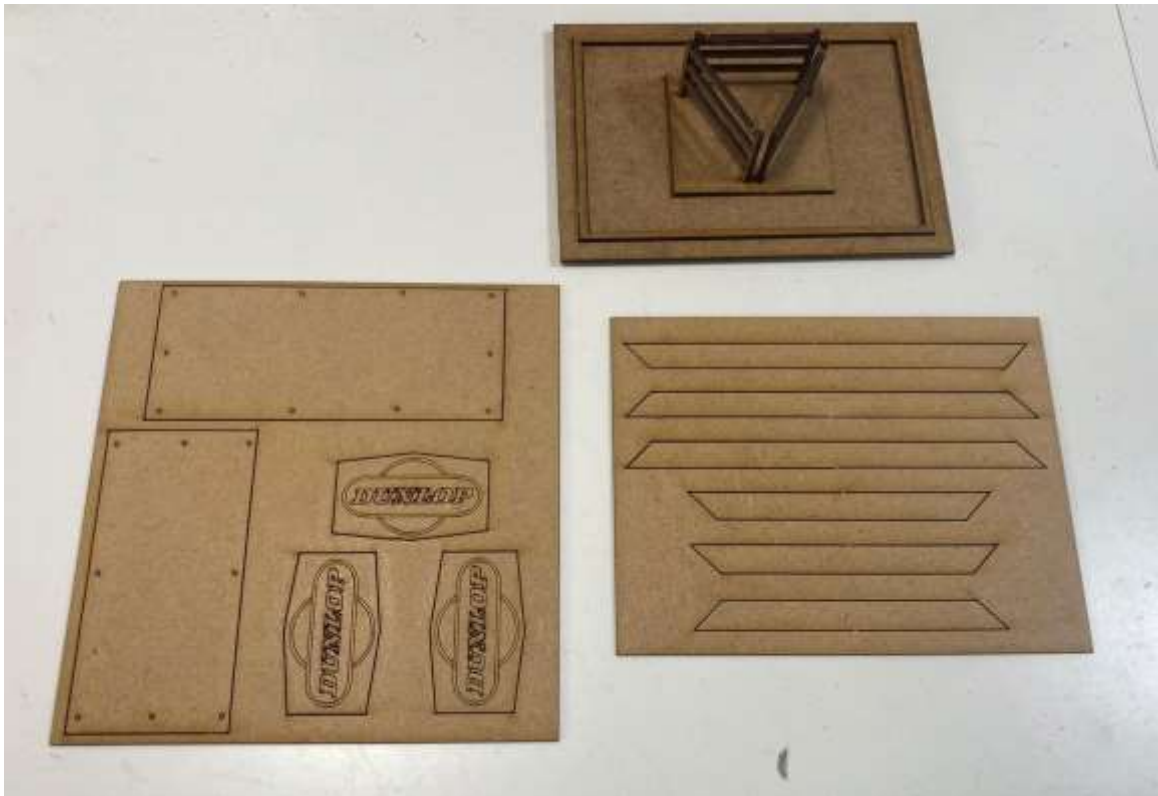

Start with one of the longer strips (Piece 35) and fit this like the diagram below.

Then work your way around the roof until you have done all 4 sides.

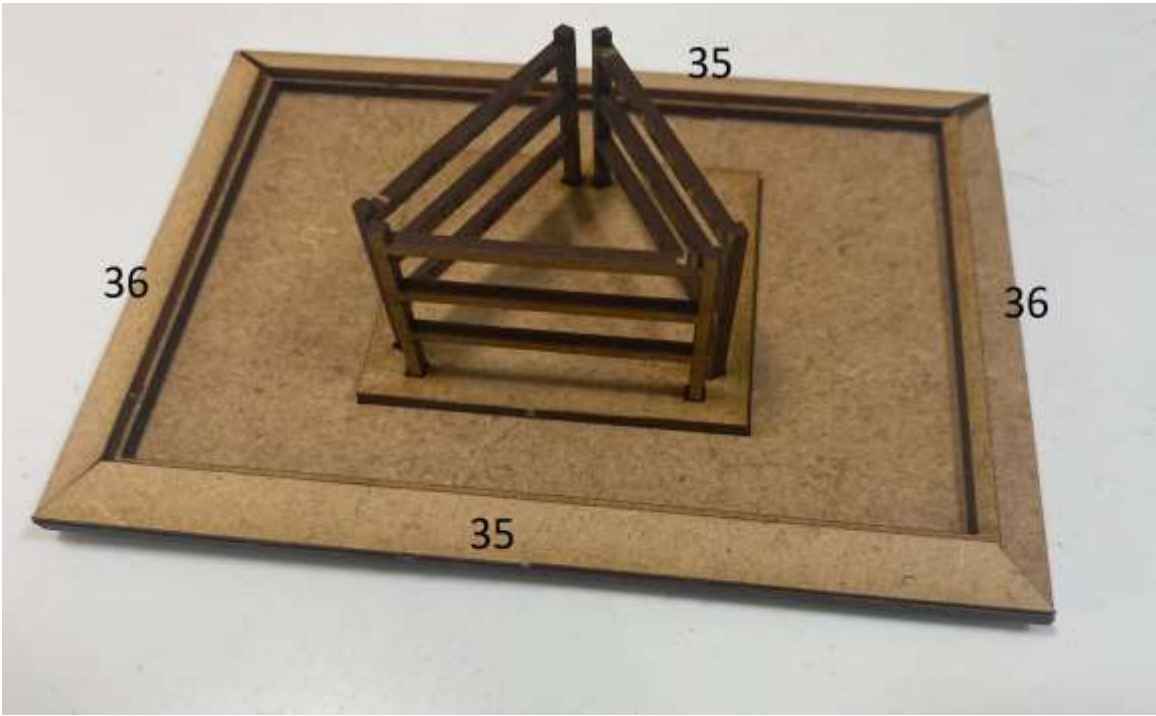
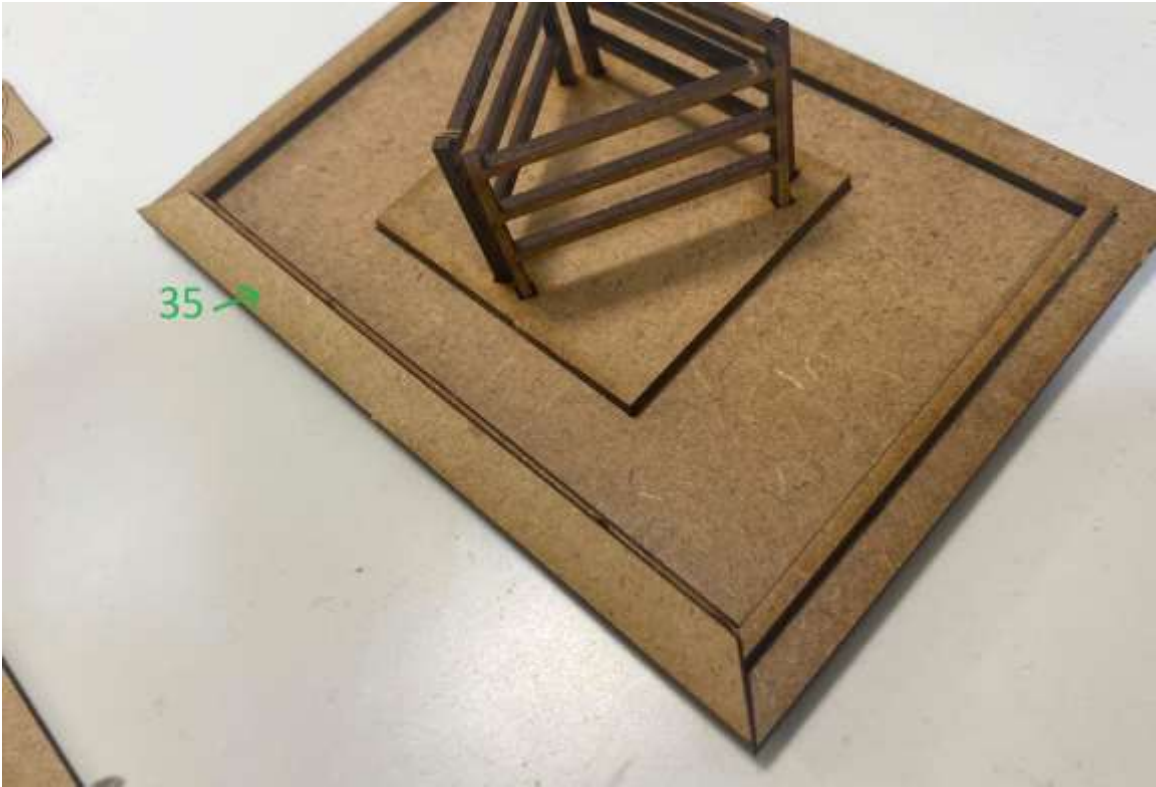

Finally, we can add the Dunlop signage boards. (Pieces 37x3)

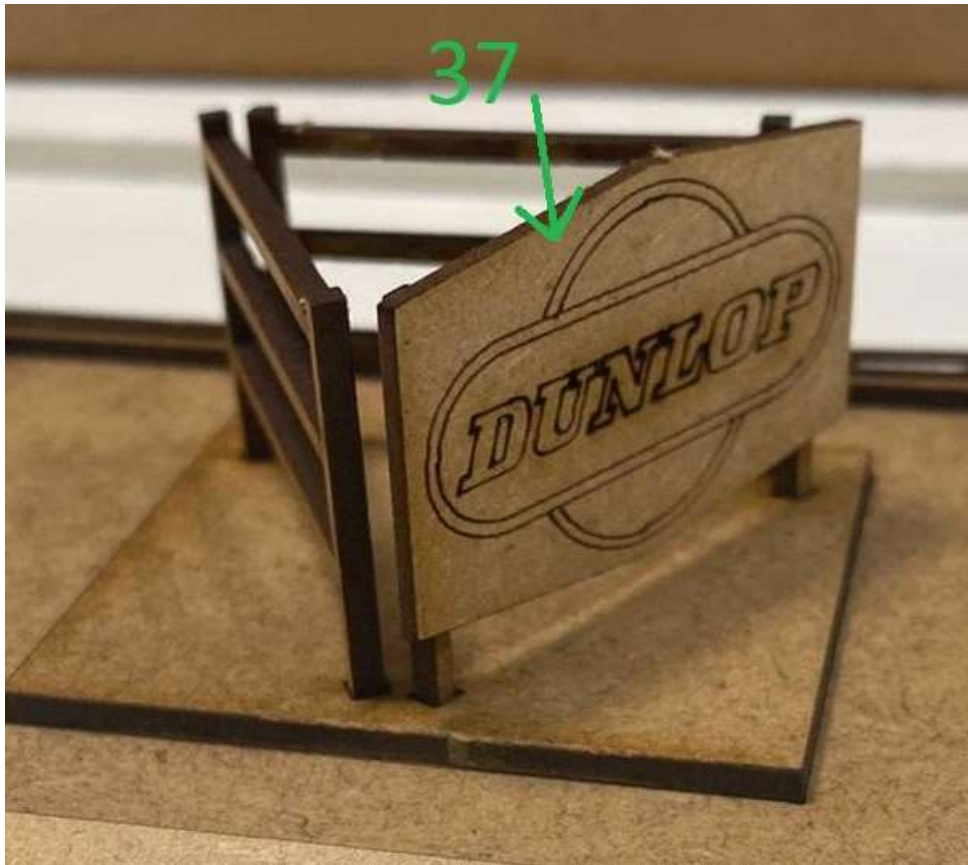

*****DO NOT GLUE THIS ONTO THE BUILDING*****

Once complete this will just sit on top and can be removed to create or modify interiors.



STEP 14

We can now start fitting all the windowsills and the door frame to the small out building.

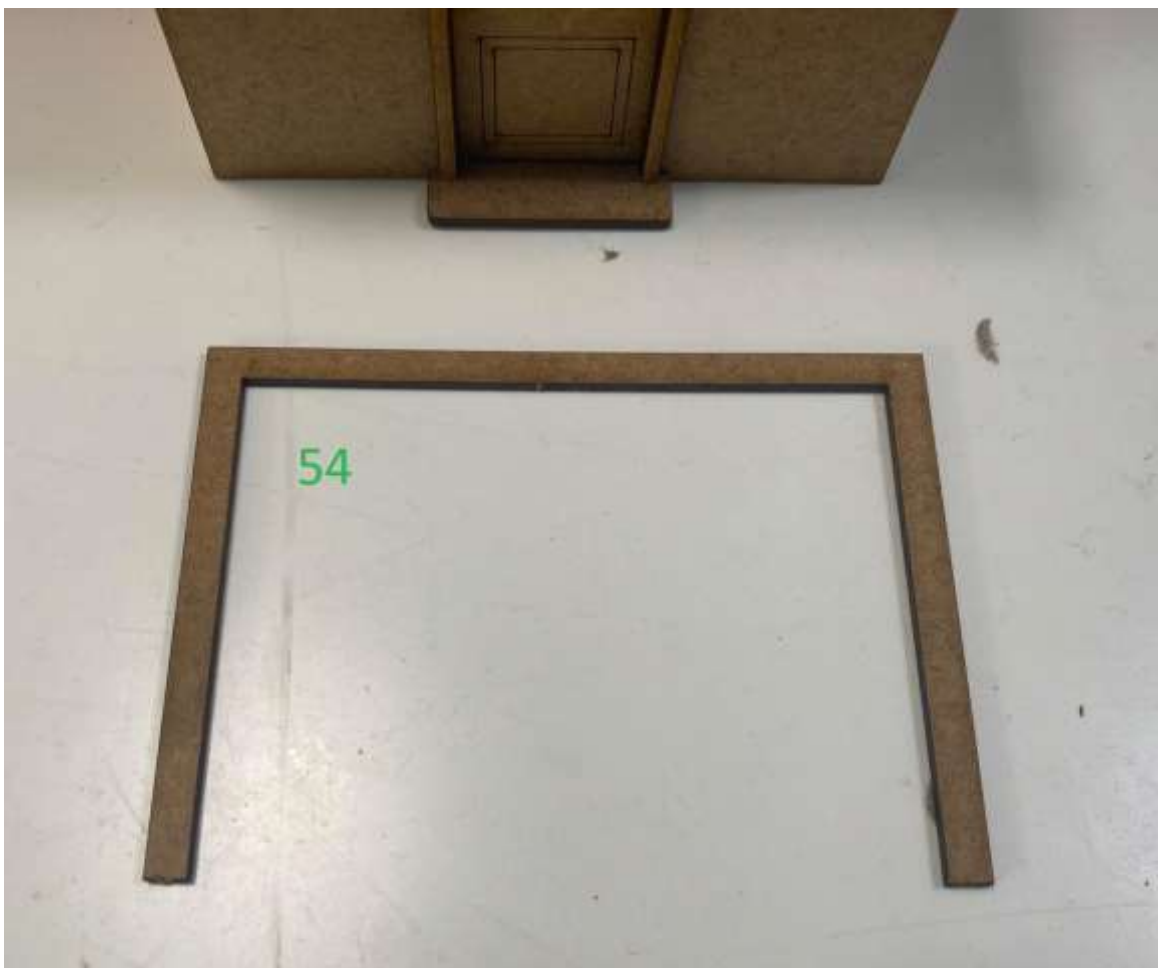
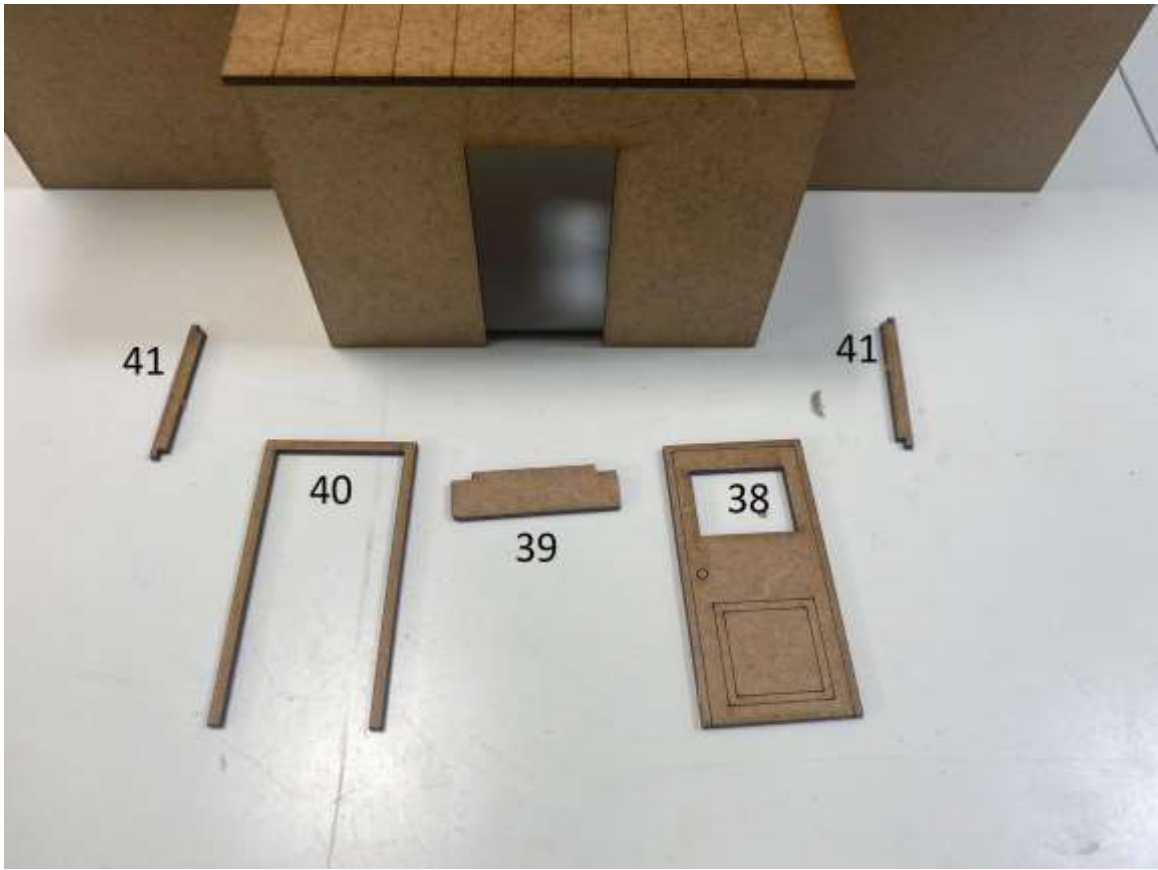

Piece 54 is an INTERNAL frame that fits inside the building over the lugs.



Slot the windowsills into place. (Do both sides)

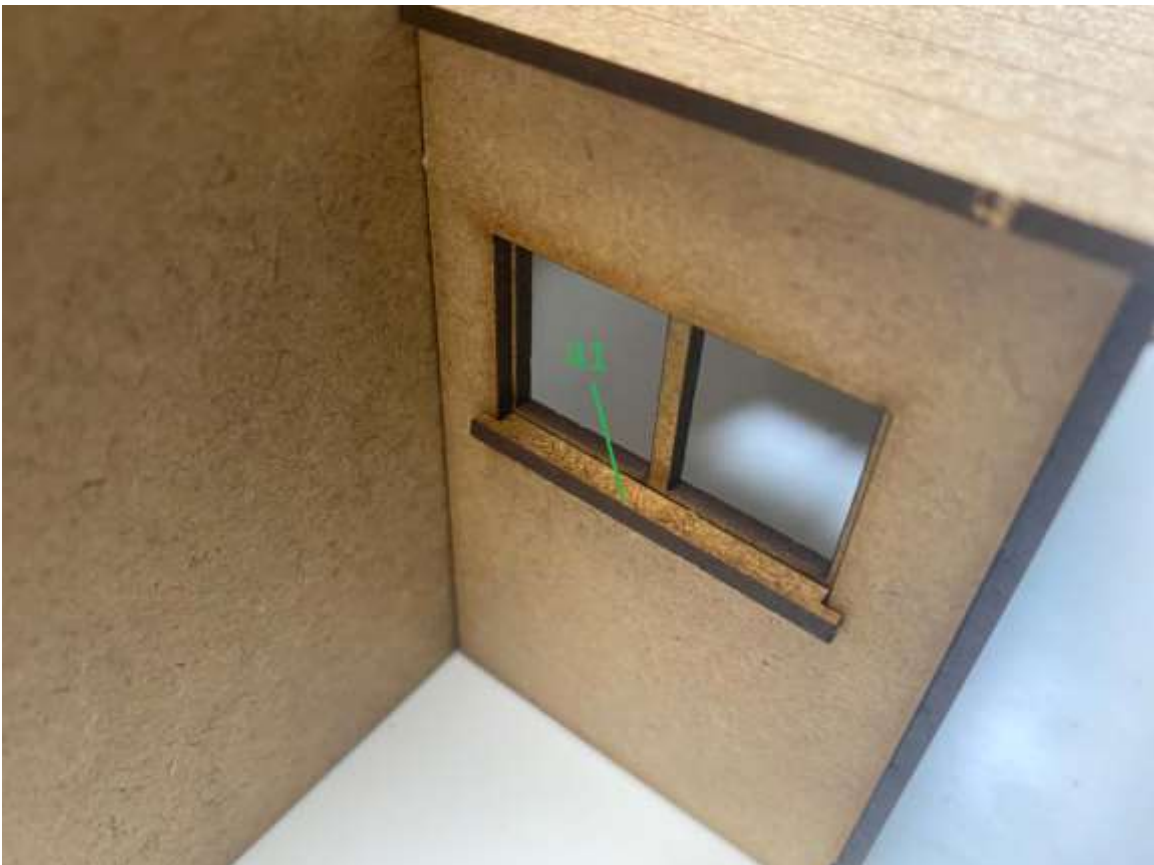

The door fits on from behind and will sit snugly into the inner wall.

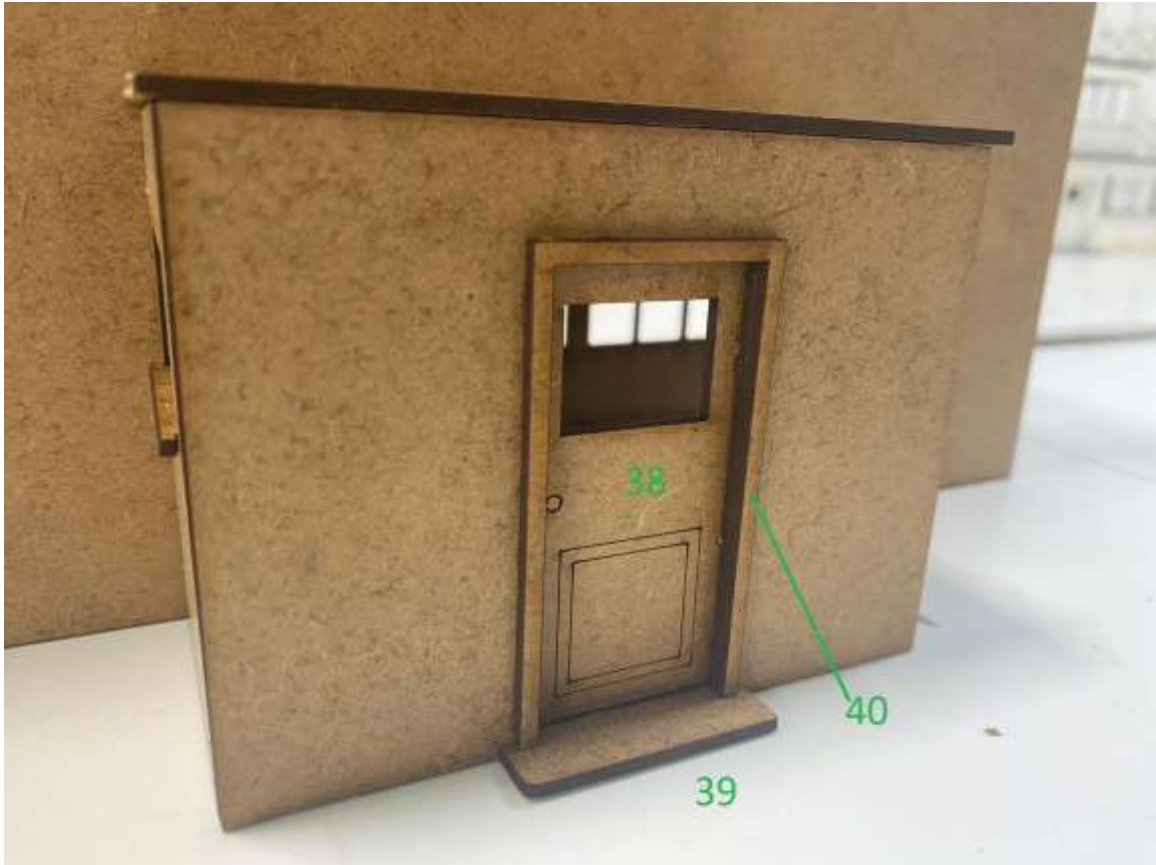

STEP 15

Now for the windowsills on the main building. Some of the longer pieces are quite fragile so take care removing them from the sheets and fitting.

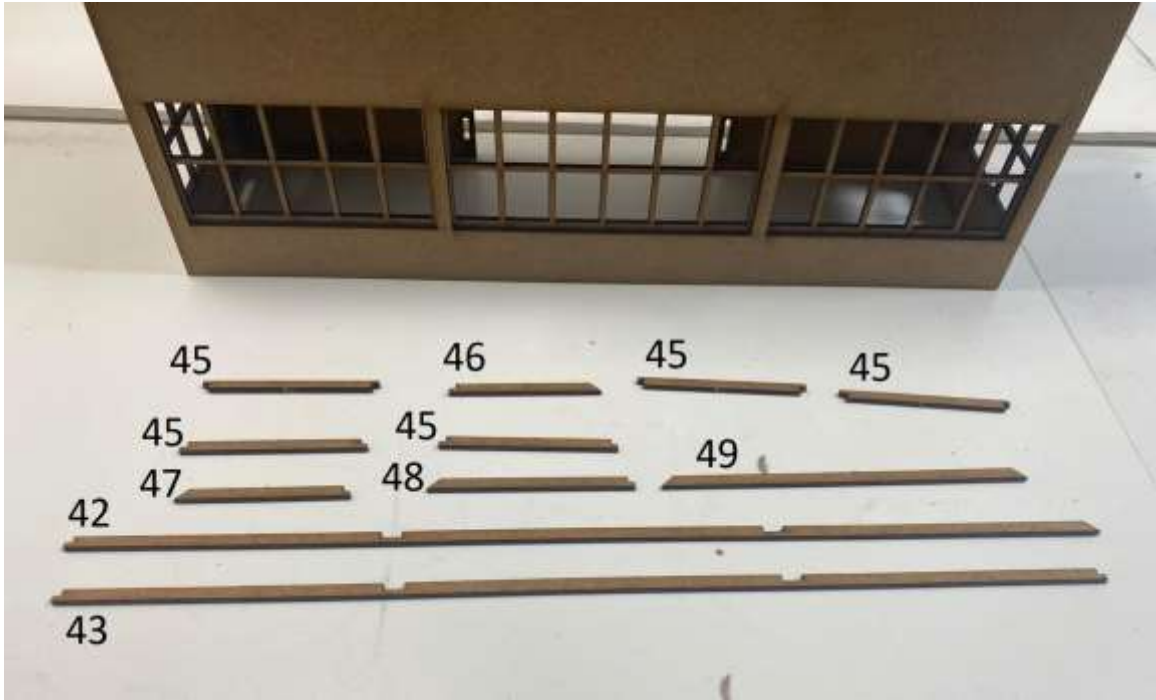

Let's start from the bottom so you'll need piece 43 and two 45's.

These fit on the way the windowsills did on the outbuilding.

The long one at the front and the smaller ones either side.

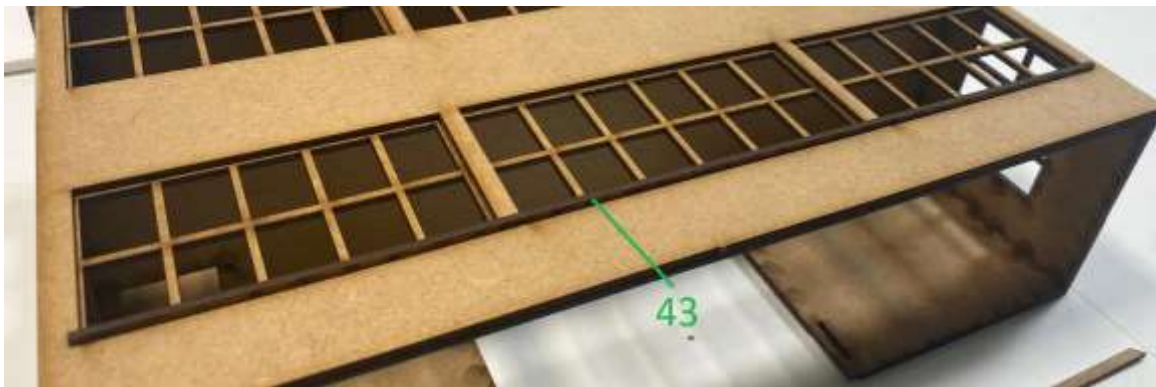

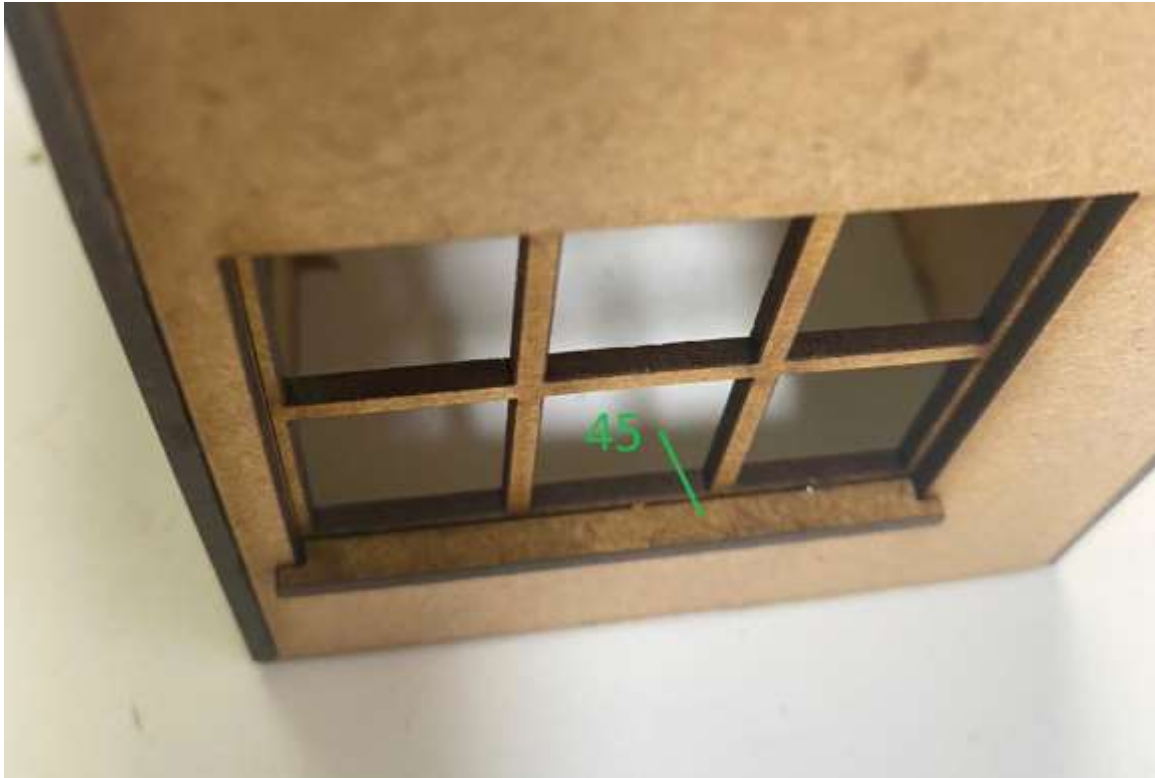

Now we can do the middle floor.

You will need pieces 42,45 and 48 for this.

(Please note piece 48 is longer than pieces 46 and 47)

Once again these fit on in the same manor. The angled cuts on pieces 42 and 48 will butt up with each other on the right-hand side of the building.

Piece 45 will slot into the left window.

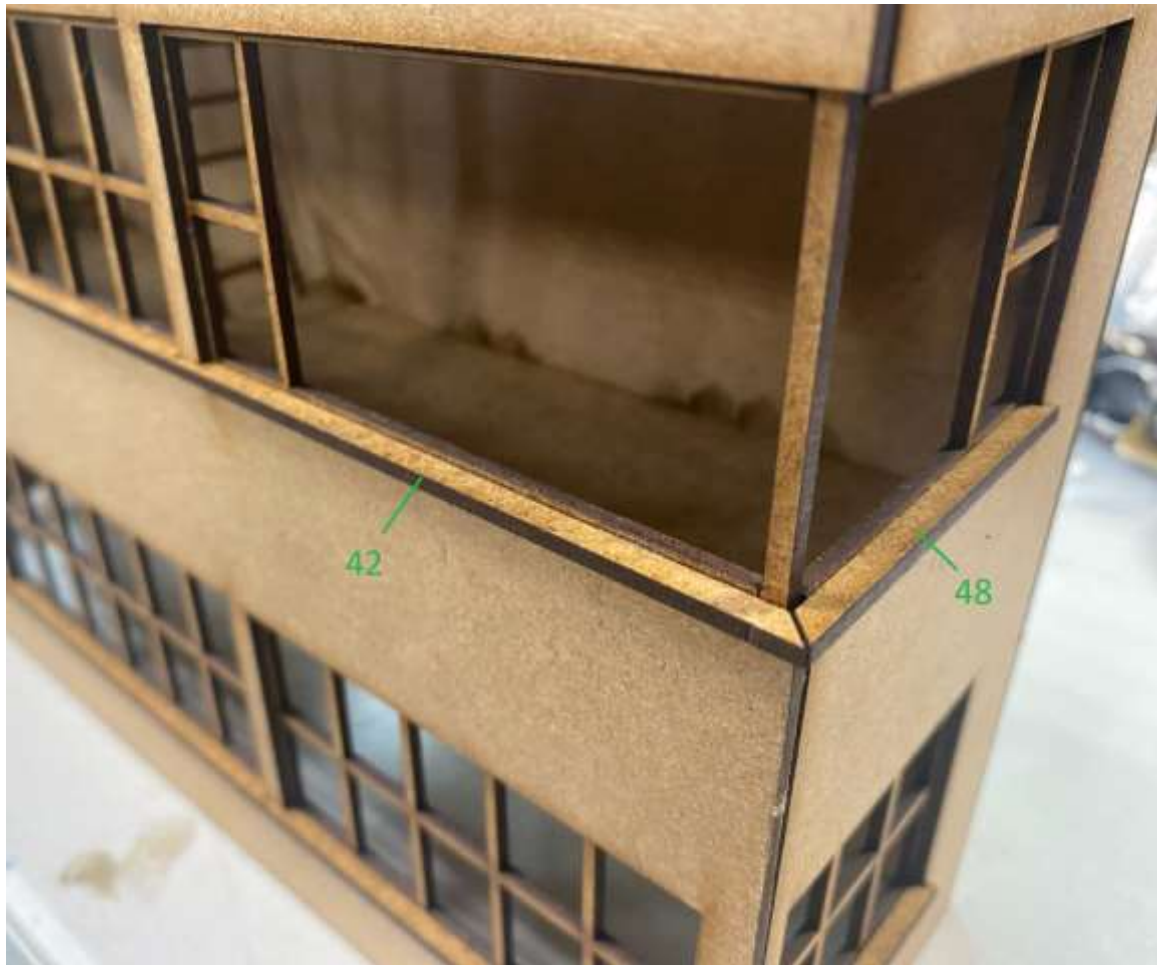

Now it's time for the top floor windows.

The long sill at the front (piece 49) and then piece 46 on the left and 47 to the right.

When fitting the long sill make sure it fitted dead centre.

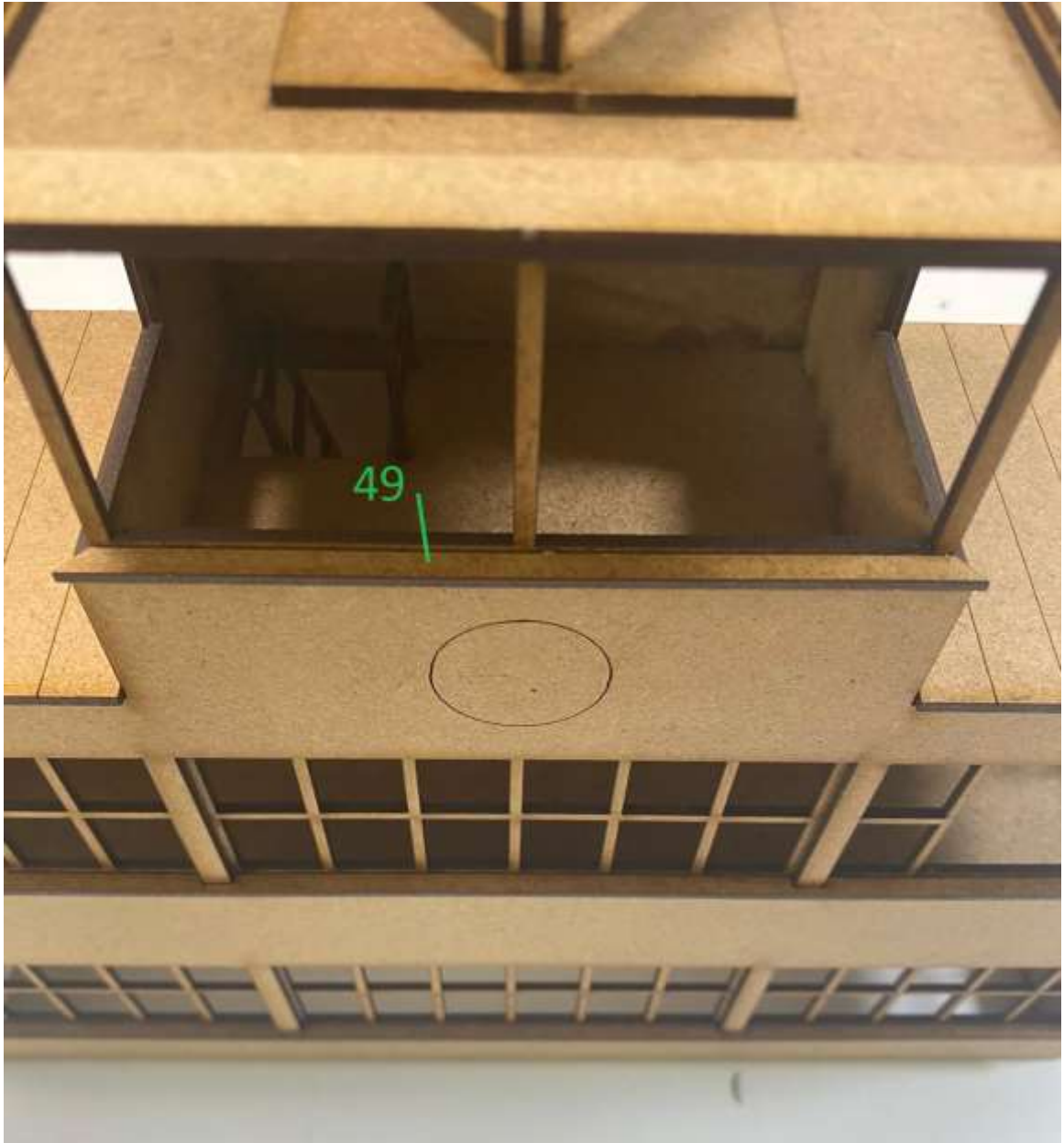

Then slot the side sills into place.

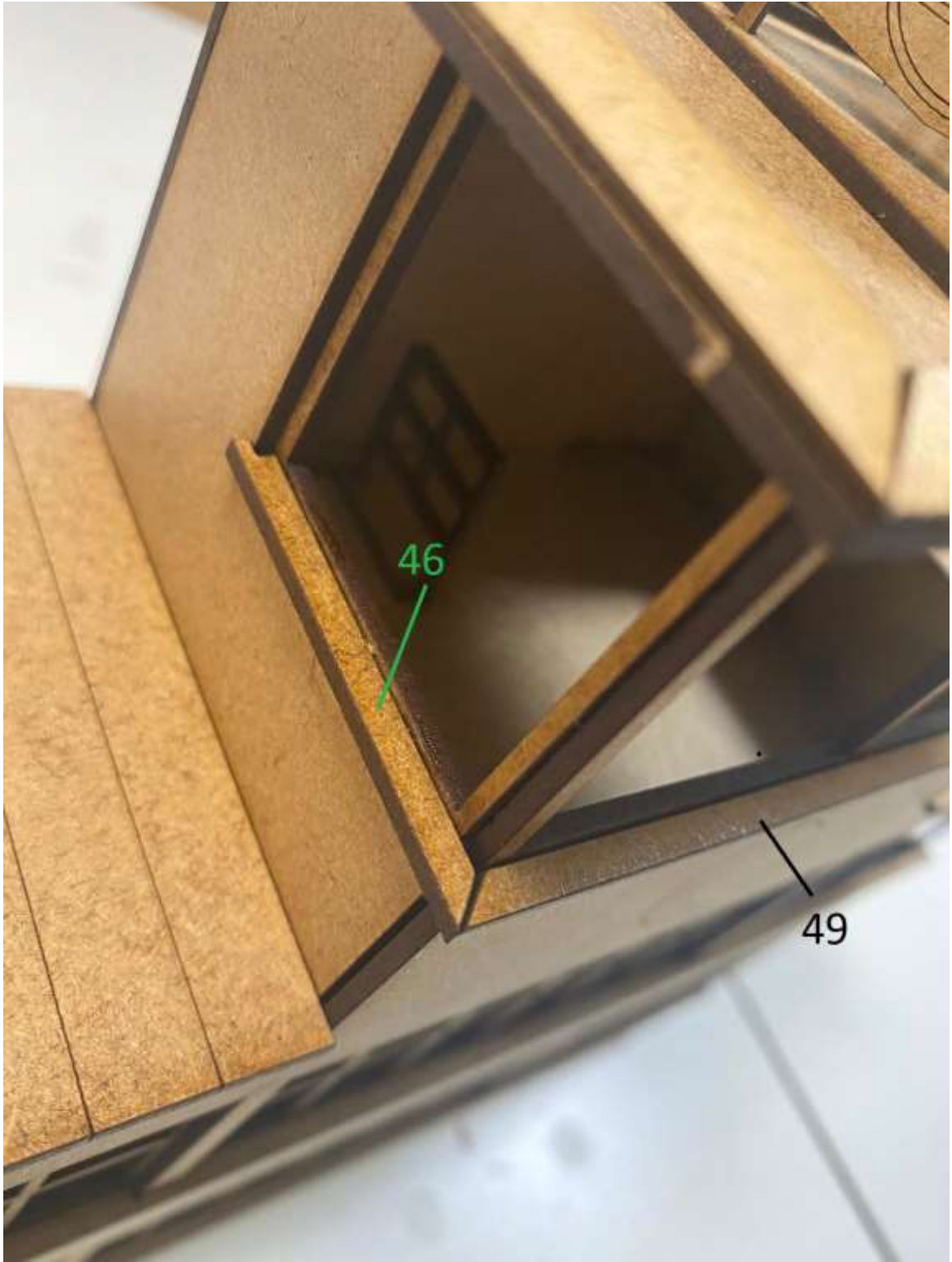

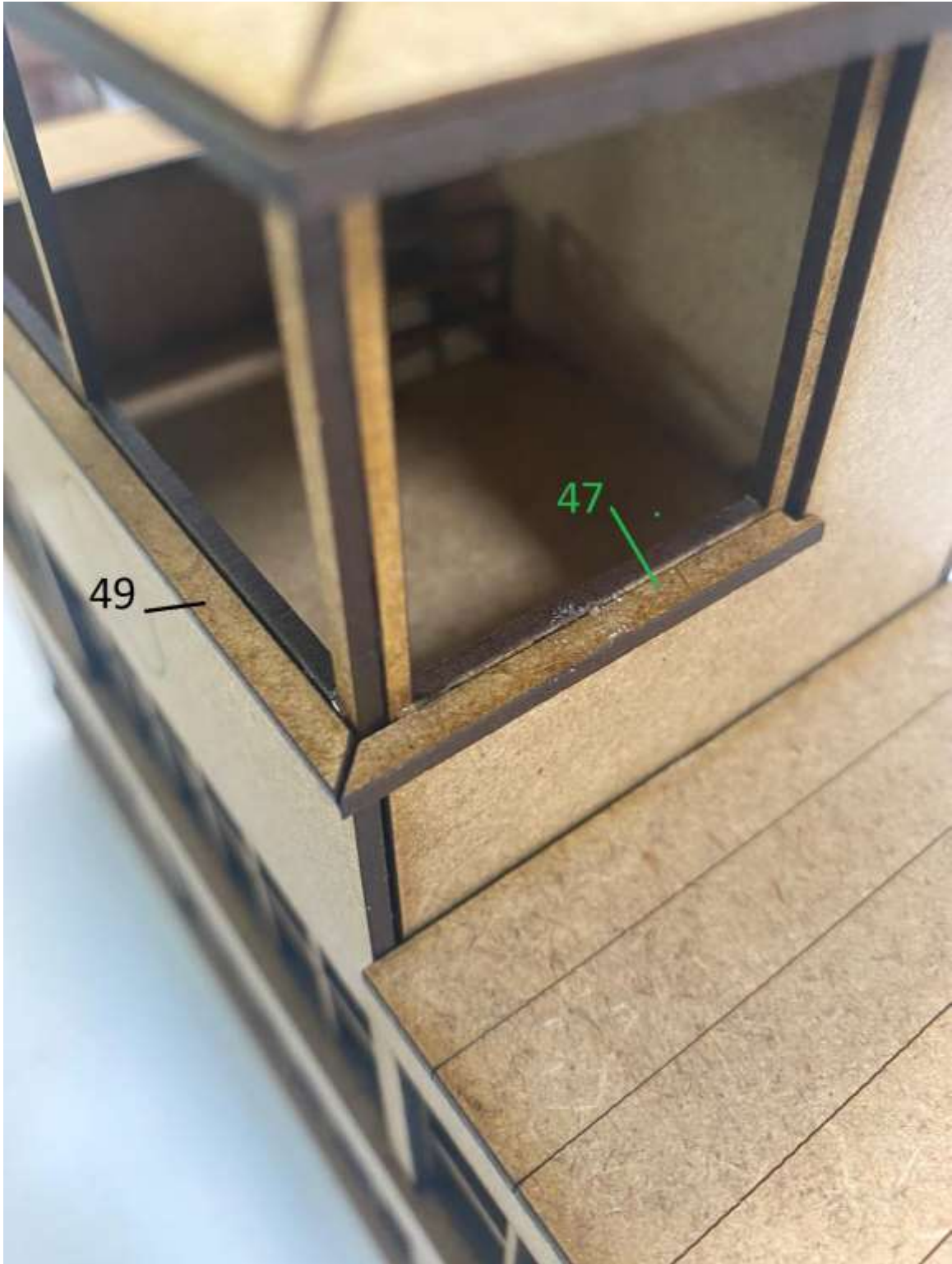

STEP 16

Nice easy step next, piece 50 the clock.



STEP 17

You will have a few pieces left in your kit.

A couple of ladders use as access to each floor, the barbed end is designed to be at the top to stop the ladder falling in.

There are 2 rectangle 1mm pieces these can be used if you wish to give the impression that a couple of the windows are boarded up. One of the main pictures we have of this building are of the left and middle window on the second floor boarded up.



You will also have a bottom floor piece. If you are wanting to add a detailed interior, then you can make it on this piece then slot the building over the top.

There is an etched line on the floor use this as a guide to trim the back off if you decided not to add the small outbuilding to the rear.

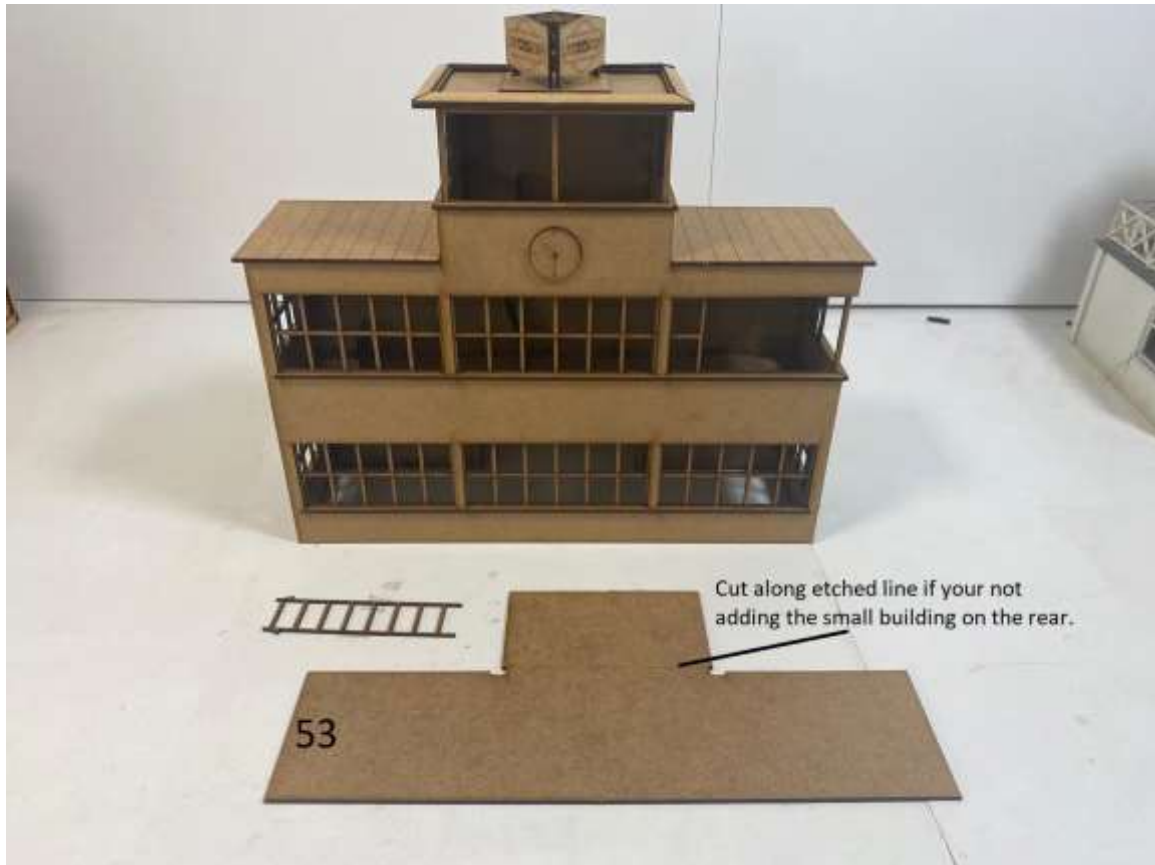

CONGRATULATIONS!!!!!! We hope you enjoyed creating your Bathurst building and please make sure to send us pictures of it on your track to marketing@magneticracing.com, as we love to see where they're living and tag us on one of the many social media platforms

Instagram/Facebook: @magneticracing
Twitter: @magnetic_racing)

Instagram/Facebook/Twitter: @thinkscalextric

Thank you again for purchasing from us.

Any feedback, good or not so good, is welcome. If there is a building you would like to see in our range, please do let us know.

feedback@magneticracing.com

